



Since 1969



**CR & FR - ROTATEURS HYDRAULIQUES**

**CR & FR - HYDRAULIC ROTATORS**

*Hydraulic  
Electronic*

# | TABLE DES MATIÈRES - INDEX

Introduction	1
Sélection CR	2
Sélection FR	6
Code	7
Dimensions CRA	9
Dimensions CRF	16
Dimensions CRH	21
Dimensions CRM	24
Dimensions FR	26
Accessoires	33
Vues explosées	40
Garantie	43

Introduction	1
CR Selection	2
FR Selection	6
Ordering Code	7
CRA Dimensions	9
CRF Dimensions	16
CRH Dimensions	21
CRM Dimensions	24
FR Dimensions	26
Accessories	33
Exploded views	40
Warranty	43

**Note :** Toutes les spécifications dans cette brochure se rapportent au produit standard en date d'aujourd'hui.  
Canimex se réserve le droit d'interrompre, de modifier ou de réviser les spécifications de cette brochure sans préavis.

**Note :** All specifications in this brochure refer to the standard product at this date.  
Canimex reserves the right to discontinue, modify or revise the specification shown in this brochure without notice.

**Attention :** Toutes les dimensions de cette brochure inscrites directement sur les dessins sont en millimètres et demeurent approximatives.  
Pour des applications où les dimensions sont critiques, contacter Canimex.

**Warning :** All dimensions in this brochure shown on drawings are in millimetres and are approximate dimensions.  
If your applications have space limitations, please contact Canimex.

## INFORMATION GÉNÉRALE / GENERAL INFORMATION

Finn-Rotor est aujourd'hui l'un des principaux fabricants de rotateurs hydrauliques, mais la première compagnie au monde à avoir développé et mis sur le marché ce type de rotateurs.

Grâce à leur vaste expérience, Finn-Rotor mise sur les nouveaux rotateurs **CR** de haute qualité, fiables et à des prix compétitifs. La gamme **FR** reste disponible.

Nos rotateurs sont examinés et testés au Centre de Recherche Technique de la Finlande. Ils sont également marqués CE conformément aux normes européennes et sont garantis de se conformer aux exigences.

Nous tenons à répondre aux exigences de nos clients tout en respectant les normes environnementales.

Notre objectif est votre satisfaction.

Finn-Rotor is one of the leading manufacturers of hydraulic rotators and is the first company in the world to have developed the rotator type it uses.

Thanks to their extensive experience, the new **CR** rotators are high quality, reliable and price competitive. **FR** series stay available.

Our rotators are examined and test loaded at the Technical Research Center of Finland. They are also marked with CE in compliance with the machine directive and are guaranteed to comply with the requirements.

We wish to meet our customer's requirements and fulfill our own goal without adding unnecessary burdens to the environment.

Our goal is to attain the satisfaction of our customers.



CR A

CR100/300/400/500



CR304/404



CR310/410

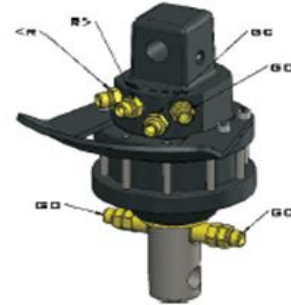

CR320



CR600

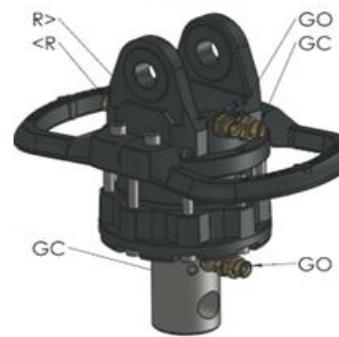

	CR100	CR300;CR304;CR310; CR320	CR400;CR404;CR410	CR500	CR600
Angle de rotation Rotation angle	Illimité Unlimited	Illimité Unlimited	Illimité Unlimited	Illimité Unlimited	Illimité Unlimited
Pression max [R] Max Pressure [R]	bar(psi) bar(psi)	250 (3625)	250 (3625)	250 (3625)	250 (3625)
Pression max [GO] Max Pressure [GO]	bar(psi) bar(psi)	200 (2900)	200 (2900)	200 (2900)	200 (2900)
Pression max [GC] Max Pressure [GC]	bar(psi) bar(psi)	300 (4350)	300 (4350)	300 (4350)	300 (4350)
Cylindrée Displacement	cm <sup>3</sup> /rév (po <sup>3</sup> /rév) cm <sup>3</sup> /rév (po <sup>3</sup> /rév)	139 (11.58)	330 (19.8)	465 (27.9)	670 (40.9)
Couple Torque	Nm(lbf po) Nm(lbf in)	450 (332)	900 (664)	1400 (1033)	1800 (811)
Force max axiale stat Max axial load stat	kN(lbf) kN(lbf)	10 (2248)	30 (6744)	40 (8992)	55 (12365)
Force max axiale dyn Max axial load dyn	kN(lbf) kN(lbf)	5 (1124)	15 (3372)	20 (4496)	25 (5620)
Poids Weight	kg(lb) kg(lb)	10 (22)	17 (37.4)	23 (50.6)	28 (61.6)
Poids [304/310/320/410] Weight [304/310/320/410]	kg(lb) kg(lb)	-	16 (35.2)	22 (48.4)	38 (83.6) [Modèle/Model W] 41 (90.2) [Modèle/Model X]
Connexions Connections	G 1/4"	G3/8", JIC8	G3/8", JIC8	G 3/8"	G1/2"
Débit req. huile Req. oil flow	lpm(gpm) lpm(gpm)	10 (2.64)	20 (5.28)	20 (5.28)	20 (5.28)

CR F



	CR300F	CR400F	CR400F A68	CR500F	
Angle de rotation / Rotation angle	Illimité / Unlimited	Illimité / Unlimited	Illimité / Unlimited	Illimité / Unlimited	
Pression max / Max pressure [R]	bar(psi) 250 (3625)	250 (3625)	250 (3625)	250 (3625)	
Pression max / Max pressure [GO]	bar(psi) 200 (2900)	200 (2900)	200 (2900)	200 (2900)	
Pression max / Max pressure [GC]	bar(psi) 300 (4350)	300 (4350)	300 (4350)	300 (4350)	
Cylindrée / Displacement	cm <sup>3</sup> /rév(in <sup>3</sup> /rev)	330 (20.1)	420 (25.6)	420 (25.6)	465 (28.4)
Couple / Torque	Nm(lbf in)	900 (664)	1100 (811)	1100 (811)	1400 (1033)
Force max axiale stat / Max axial load stat	kN(lbf)	30 (6744)	40 (8992)	50 (11241)	55 (12365)
Force max axiale dyn / Max axial load dyn	kN(lbf)	15 (3372)	20 (4496)	25 (5620)	25 (5620)
Poids / Weight	kg(lb)	22 (48.4)	28 (61.6)	30 (66)	33 (72.6)
Connexions / Connections	dessus(top)	G3/8"	G3/8"	G3/8"	G3/8"
Connexions / Connections	dessous(bottom)	G1/4"	G3/8"	G3/8"	G3/8"
Débit req. huile / Req. oil flow	lpm(gpm)	20 (5.284)	20 (5.284)	20 (5.284)	20 (5.284)

	CR600 F173	CR600 B173	
Angle de rotation / Rotation angle	Illimité / Unlimited	Illimité / Unlimited	
Pression max / Max pressure [R]	bar(psi) 250 (3625)	250 (3625)	
Pression max / Max pressure [GO]	bar(psi) 200 (2900)	200 (2900)	
Pression max / Max pressure [GC]	bar(psi) 300 (4350)	300 (4350)	
Cylindrée / Displacement	cm <sup>3</sup> /rév(in <sup>3</sup> /rev)	670 (40.9)	670 (40.9)
Couple / Torque	Nm(lbf in)	1800 (664)	1800 (811)
Force max axiale stat / Max axial load stat	kN(lbf)	60 (13489)	80 (17985)
Force max axiale dyn / Max axial load dyn	kN(lbf)	30 (6744)	40 (8992)
Poids Modèle-W / Weight W-Model	kg(lb)	48 (106)	45 (99)
Poids Modèle-X/ Weight X-Model	kg(lb)	50 (110)	48 (105.6)
Connexions / Connections	dessus(top)	G1/2"	G1/2"
Connexions / Connections	dessous(bottom)	G1/2"	G1/2"
Débit req. huile / Req. oil flow	lpm(gpm)	20 (5.284)	20 (5.284)

CR H

CRH W-MODEL

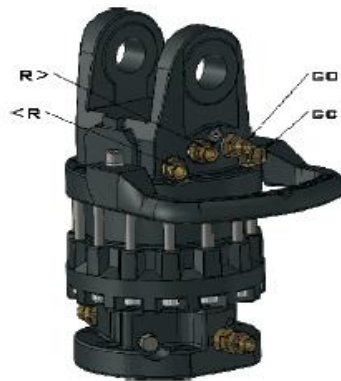

CRH X-MODEL

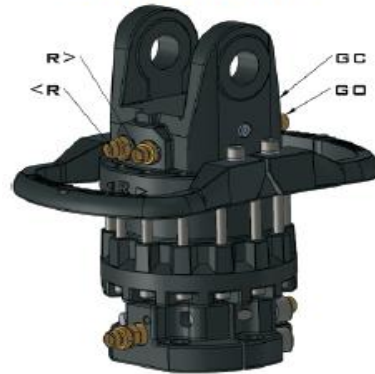

	CR800H	CR1000H	CR1200H	CR1600H
Angle de rotation / Rotation angle	Illimité / Unlimited	Illimité / Unlimited	Illimité / Unlimited	Illimité / Unlimited
Pression max / Max pressure [R]	bar(psi) 250 (3625)	250 (3625)	250 (3625)	250 (3625)
Pression max / Max pressure [GO]	bar(psi) 300 (4350)	300 (4350)	300 (4350)	300 (4350)
Pression max / Max pressure [GC]	bar(psi) 300 (4350)	300 (4350)	300 (4350)	300 (4350)
Cylindrée / Displacement	cm <sup>3</sup> /rév(in <sup>3</sup> /rev) 670 (40.9)	810 (49)	949 (57)	1265 (77.2)
Couple / Torque	Nm(lbf in) 2000 (1475)	2700 (1991)	2900 (2139)	3600 (2655)
Force max axiale stat / Max axial load stat	kN(lbf) 80 (17985)	100 (22481)	120 (26911)	160 (35970)
Force max axiale stat [tirer]	kN(lbf) -40 (-8992)	-80 (-17985)	-90 (-20233)	-90 (-20233)
Max axial load stat[tirer]	kN(lbf) -40 (-8992)	-80 (-17985)	-90 (-20233)	-90 (-20233)
Force max axiale dyn / Max axial load dyn	kN(lbf) 40 (8992)	50 (11241)	60 (13489)	80 (17985)
Force max axiale dyn[tirer]	kN(lbf) -20 (-4496)	-40 (-8992)	-45 (-10116)	-45 (-10116)
Max axial load dyn[pull]	kN(lbf) -20 (-4496)	-40 (-8992)	-45 (-10116)	-45 (-10116)
Poids Modèle-W / Weight W-Model	kg(lb) 51 (112.2)	64 (140.8)	76 (167.2)	78 (171.6)
Poids Modèle-X/ Weight X-Model	kg(lb) 54 (118.8)	67 (147.4)	79 (173.8)	81 (178.2)
Connexions / Connections	G1/2"	G1/2"	G1/2"	G1/2"
Débit req. huile / Req. oil flow	lpm(gpm) 25 (6.6)	25 (6.6)	25 (6.6)	30 (7.9)

## CR M



	CR800M	CR1000M	CR1200M	CR1600M
Angle de rotation / Rotation angle	Illimité / Unlimited	Illimité / Unlimited	Illimité / Unlimited	Illimité / Unlimited
Pression max / Max pressure [R]	bar(psi)	250 (3625)	250 (3625)	250 (3625)
Cylindrée / Displacement	cm <sup>3</sup> /rév(in <sup>3</sup> /rev)	670 (40.9)	810 (49)	949 (57)
Couple / Torque	Nm(lbf in)	2000 (1475)	2700 (1991)	2900 (2139)
Force max axiale stat / Max axial load stat	kN(lbf)	80 (17985)	100 (22481)	120 (26911)
Force max axiale stat [tirer]	kN(lbf)	-40 (-8992)	-80 (-17985)	-90 (-20233)
Max axial load stat[pull]	kN(lbf)			
Force max axiale dyn / Max axial load dyn	kN(lbf)	40 (8992)	50 (11241)	60 (13489)
Force max axiale dyn[tirer]	kN(lbf)	-20 (-4496)	-40 (-8992)	-45 (-10116)
Max axial load dyn[pull]	kN(lbf)			
Poids / Weight	kg(lb)	48 (105.6)	61 (134.2)	73 (160.6)
Connexions / Connections		G1/2"	G1/2"	G1/2"
Débit req. huile / Req. oil flow	lpm(gpm)	25 (6.6)	25 (6.6)	25 (6.6)

FR



FR7		Caractéristiques / Features	
Angle de rotation / Rotation angle	Illimité / Unlimited		
Pression maximale / Maximum pressure [rotation]	250 bar	3625 psi	
Cylindrée / Displacement	330 cm <sup>3</sup>	20.1 in <sup>3</sup>	
Couple / Torque	900 Nm	664 lb.ft	
Force max axiale stat / Max axial load stat	30 kN	6744 lbf	
Force max axiale dyn / Max axial load dyn	15 kN	3372 lbf	
Poids / Weight	16 kg	35 lb	
Connexions / Connections	G3/8"		
Débit req. huile / Req. oil flow	20 lpm	5.3 gpm	
FR10		Caractéristiques / Features	
Angle de rotation / Rotation angle	Illimité / Unlimited		
Pression maximale / Maximum pressure [rotation]	200 bar	2900 psi	
Cylindrée / Displacement	420 cm <sup>3</sup>	25.6 in <sup>3</sup>	
Couple / Torque	1000 Nm	738 lb.ft	
Force max axiale stat / Max axial load stat	40 kN	8992 lbf	
Force max axiale dyn / Max axial load dyn	20 kN	4496 lbf	
Poids / Weight	20 kg	44 lb	
Connexions / Connections	G3/8"		
Débit req. huile / Req. oil flow	20 lpm	5.3 gpm	
FR15		Caractéristiques / Features	
Angle de rotation / Rotation angle	Illimité / Unlimited		
Pression maximale / Maximum pressure [rotation]	200 bar	2900 psi	
Cylindrée / Displacement	464 cm <sup>3</sup>	28.3 in <sup>3</sup>	
Couple / Torque	1150 Nm	848 lb.ft	
Force max axiale stat / Max axial load stat	55 kN	12364 lbf	
Force max axiale dyn / Max axial load dyn	25 kN	5620 lbf	
Poids / Weight	25 kg	63 lb	
Connexions / Connections	G3/8"		
Débit req. huile / Req. oil flow	20 lpm	5.3 gpm	
FR21		Caractéristiques / Features	
Angle de rotation / Rotation angle	Illimité / Unlimited		
Pression maximale / Maximum pressure [rotation]	200 bar	2900 psi	
Cylindrée / Displacement	543 cm <sup>3</sup>	33.1 in <sup>3</sup>	
Couple / Torque	1350 Nm	996 lb.ft	
Force max axiale stat / Max axial load stat	55 kN	12364 lbf	
Force max axiale dyn / Max axial load dyn	25 kN	5620 lbf	
Poids / Weight	39 kg	86 lb	
Connexions / Connections	G1/2"		
Débit req. huile / Req. oil flow	20 lpm	5.3 gpm	
FR26		Caractéristiques / Features	
Angle de rotation / Rotation angle	Illimité / Unlimited		
Pression maximale / Maximum pressure [rotation]	200 bar	2900 psi	
Cylindrée / Displacement	883 cm <sup>3</sup>	53.9 in <sup>3</sup>	
Couple / Torque	2200 Nm	1622 lb.ft	
Force max axiale stat / Max axial load stat	150 kN	33721 lbf	
Poids / Weight	58 kg	128 lb	
Connexions / Connections	G1/2"		
Débit req. huile / Req. oil flow	-		
FR22M		Caractéristiques / Features	
Angle de rotation / Rotation angle	Illimité / Unlimited		
Pression max. / Max. pressure [ligne ouverte/opened line]	200 bar	2900 psi	
Cylindrée / Displacement	543 cm <sup>3</sup>	33.1 in <sup>3</sup>	
Couple / Torque	1350 Nm	996 lb.ft	
Force max axiale stat / Max axial load stat	100 kN	22480 lbf	
Force max axiale dyn / Max axial load dyn	50 kN	11240 lbf	
Poids / Weight	35 kg	77 lb	
Connexions / Connections	G1/2"		
Débit req. huile / Req. oil flow	30 lpm	7.9 gpm	



**NOMENCLATURE / ORDERING CODE**

CR	100	-W	25	A	20	-111
Série Series	Grosueur Size	Direction	Ø goupille haut Ø top pin	Type	Ø goupille arbre Ø shaft pin ou/or Bride/Flange	Connexions Connections
CR	100	<b>W</b> (Parallèle/Parallel) <b>X</b> (Perpendiculaire/ Perpendicular)	25	<b>A</b> (Arbre/Shaft)	20	<b>111</b> (Filets BSPP/GAZ threads)
			1		1	<b>222</b> (Filets BSPP/GAZ threads) <b>554</b> (Filets JIC threads)
	300		25	F (Bride/Flange)	140	222 (Filets BSPP/GAZ threads)
	304S				A (Arbre/Shaft)	
	310		F (Bride/Flange)	140		
	320			A (Arbre/Shaft)	30	
	400		F (Bride/Flange)		140	
	404S			A (Arbre/Shaft)	30	222 (Filets bspp/Gaz threads) <b>555</b> (Filets JIC threads)
	410		F (Bride/Flange)		173	222 (Filets BSPP/GAZ threads)
	500			30		
	600		35	F (Bride/Flange)	173	333 (Filets BSPP/GAZ threads)
	800H					
	1000H		45			
	1200H			45		
1600H	45					

**NOMENCLATURE / ORDERING CODE**

<b>FR</b>	<b>15</b>	<b>-W</b>	<b>30</b>	<b>A</b>	<b>30</b>	<b>-555</b>
<b>Série Series</b>	<b>Grosueur Size</b>	<b>Direction</b>	<b>Ø goupille haut Ø top pin</b>	<b>Type</b>	<b>Ø goupille arbre Ø shaft pin ou/or Bride/Flange</b>	<b>Connexions Connections</b>
<b>FR</b>	<b>7</b>	<b>W</b> (Parallèle/Parallel) <b>X</b> (Perpendiculaire/ Perpendicular)	<b>25</b>	<b>A</b> (Arbre/Shaft) <b>B</b> (Bride/Flange)	<b>25</b>	<b>554</b> (Filets JIC threads)
	<b>10</b>				<b>30</b>	
	<b>15</b>		<b>30</b>		<b>333</b> (Filets BSPP/GAS threads)	
	<b>21</b>		<b>35</b>			<b>35</b>
	<b>26</b>		<b>45</b>			<b>30</b>
	<b>22M</b>		<b>-</b>		<b>-</b>	

CR100

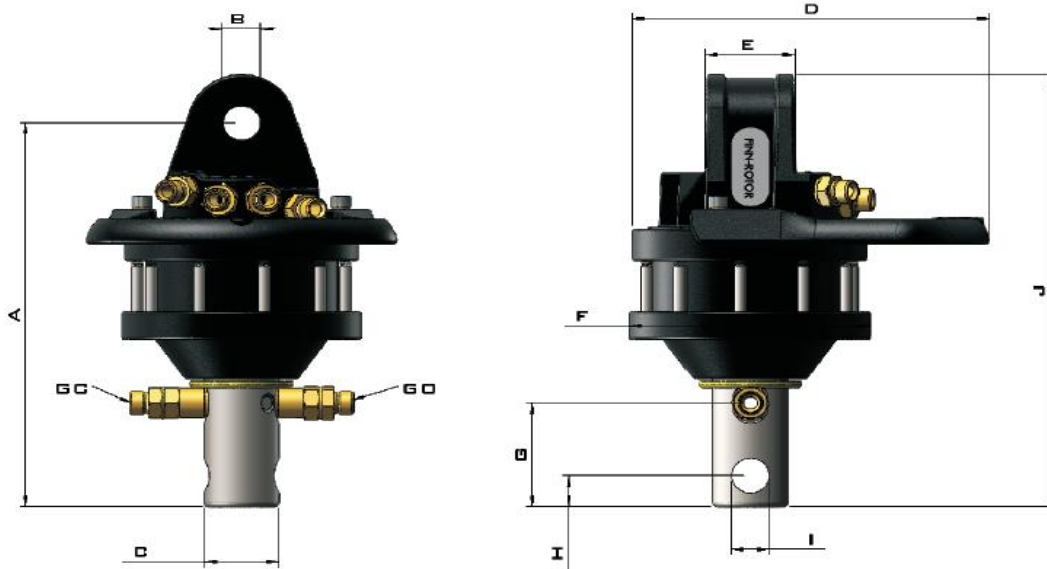

CR100A		
	mm	po (in)
A	238.5	9.390
B	25.0	0.984
C	39.5	1.555
D	194.0	7.638
E	45.0	1.772
F	137.0	5.394
G	59.0	2.323
H	19.0	0.748
I	20.0	0.787
J	268.5	20.571

CR300

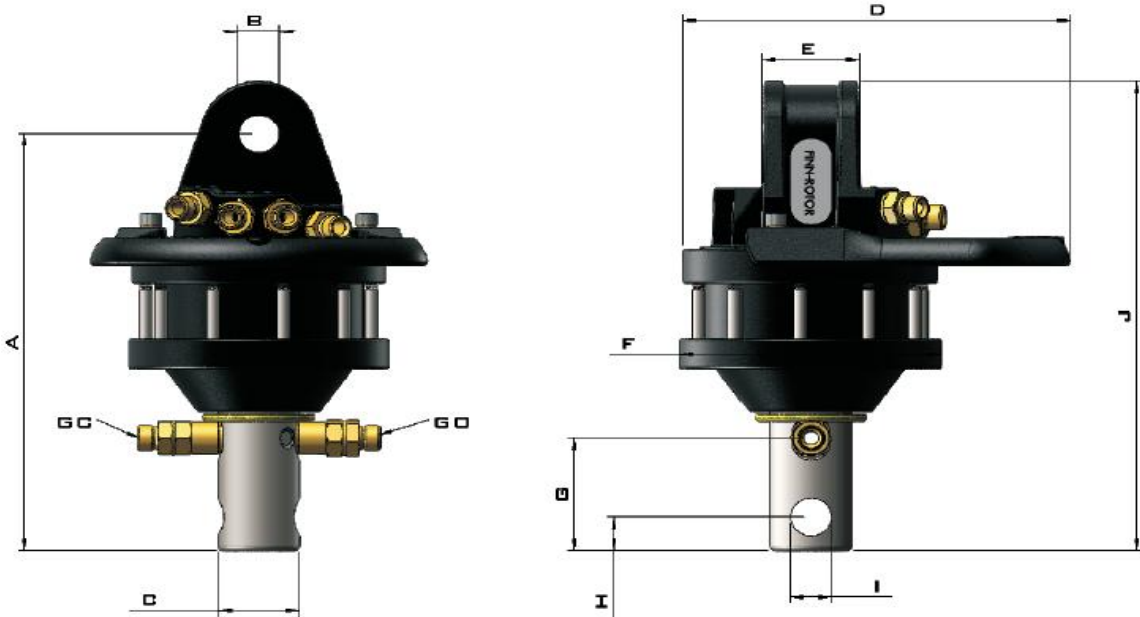

CR300A		
	mm	po (in)
A	277.5	10.925
B	25.0/25.4	0.984
C	49.5	1.949
D	239.0	9.409
E	60.0	2.362
F	158.0	6.220
G	75.0	2.953
H	22.5	0.886
I	25.0/25.4	0.948
J	312.5	12.303

CR304S		
	mm	po (in)
A	277.5	10.925
B	25.0	0.984
C	49.5	1.949
D	225.0	8.858
E	60.0	2.362
F	158.0	6.220
G	75.0	2.953
H	22.5	0.886
I	25.0	0.948
J	312.5	12.303

CR310A		
	mm	po (in)
A	285.0	11.220
B	24.0	0.984
C	49.5	1.949
D	240.0	9.449
E	60.0	2.362
F	158.0	6.220
G	75.0	2.923
H	22.5	0.886
I	25.0	0.984
J	316.0	12.441

CR300

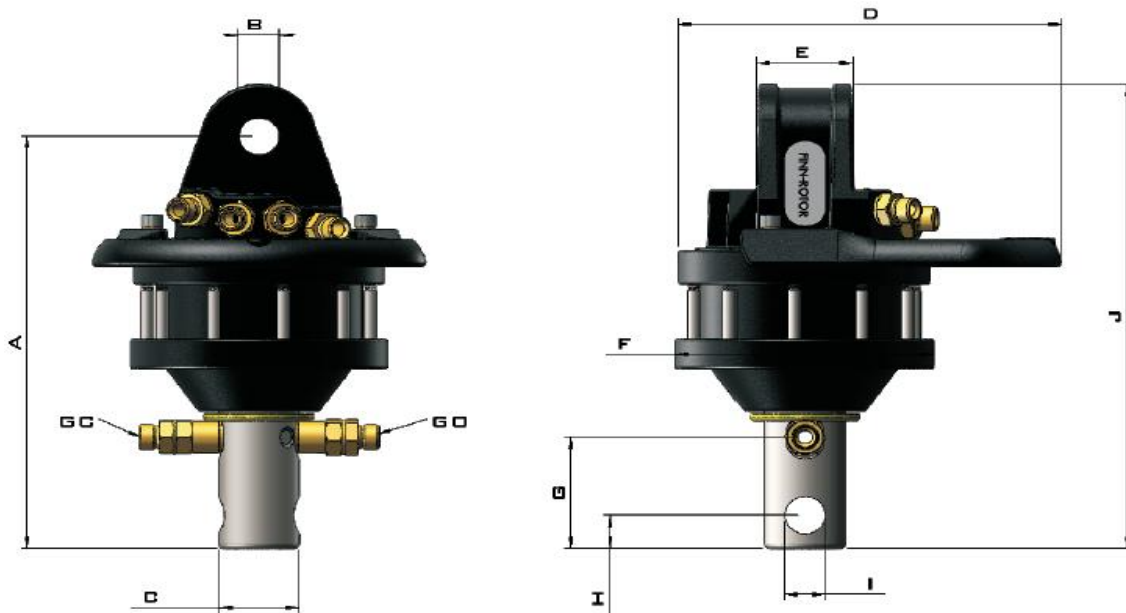

CR310XA		
	mm	po (in)
A	285.0	11.220
B	24.0	0.945
C	49.5	1.949
D	240.0	9.449
E	60.0	2.362
F	158.0	6.220
G	75.0	2.923
H	22.5	0.886
I	24.0	0.945
J	316.0	12.441



CR320A		
	mm	po (in)
A	285.0	11.220
B	25.0	0.948
C	49.5	1.949
D	239.0	9.409
E	60.0	2.362
F	158.0	6.220
G	75.0	2.953
H	22.5	0.886
I	25.0	0.948
J	316.0	12.441



CR320XA		
	mm	po (in)
A	285.0	11.220
B	24.0	0.945
C	49.5	1.949
D	239.0	9.409
E	60.0	2.362
F	158.0	6.220
G	75.0	2.953
H	22.5	0.886
I	24.0	0.945
J	316.0	12.441

CR400

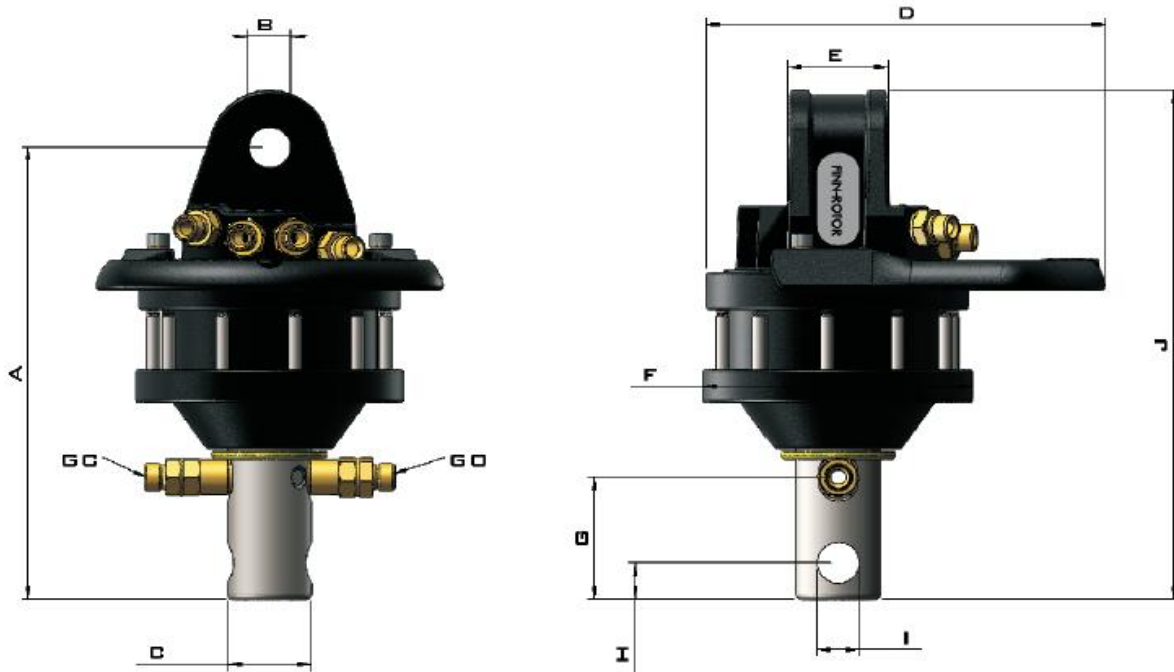

CR400A		
	mm	po (in)
A	301.0	11.850
B	25.0	0.984
C	59.0	2.323
D	237.0	9.331
E	73.0	2.874
F	172.0	6.772
G	84.0	3.307
H	28.0	1.102
I	30.0	1.181
J	341.0	13.425

CR404S		
	mm	po (in)
A	301.0	11.850
B	25.0	0.984
C	59.0	2.323
D	240.0	9.449
E	73.0	2.874
F	172.0	6.772
G	84.0	3.307
H	28.0	1.102
I	30.0	1.181
J	341.0	13.425

CR400

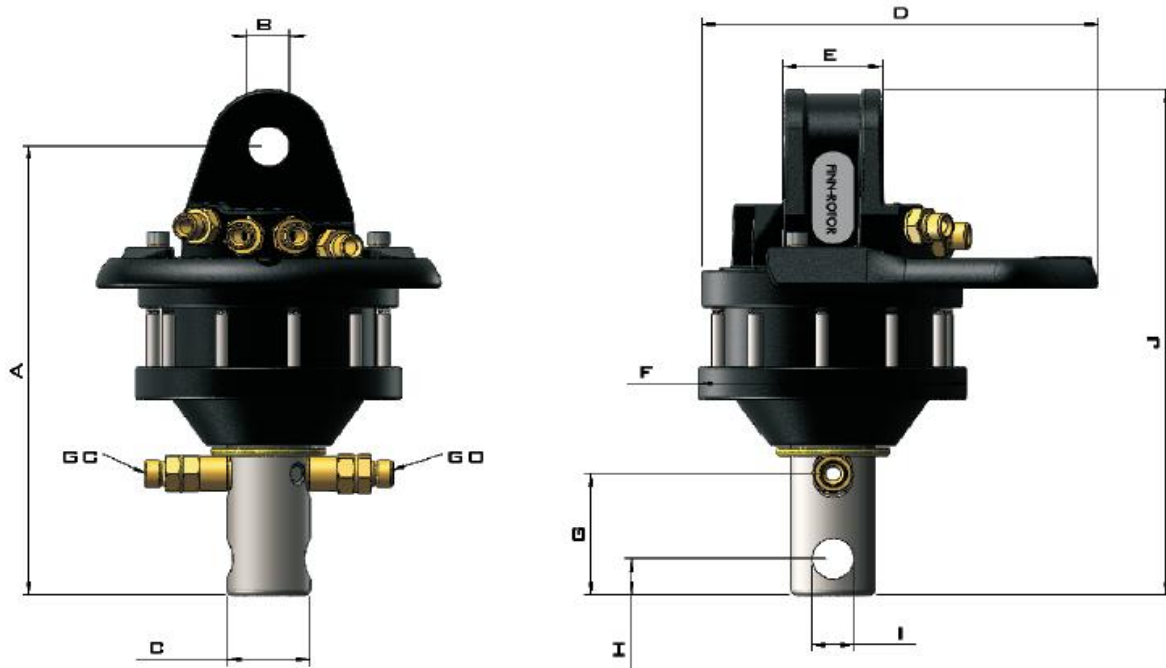

CR410A		
	mm	po (in)
A	317.0	12.480
B	25.0	0.984
C	59.0	2.323
D	258.0	10.157
E	73.0	2.874
F	172.0	6.772
G	84.0	3.307
H	28.0	1.102
I	30.0	1.181
J	347.0	13.661

CR410XA		
	mm	po (in)
A	317.0	12.480
B	25.0	0.984
C	59.0	2.323
D	258.0	10.157
E	73.0	2.874
F	172.0	6.772
G	84.0	3.307
H	28.0	1.102
I	30.0	1.181
J	347.0	13.661

CR500

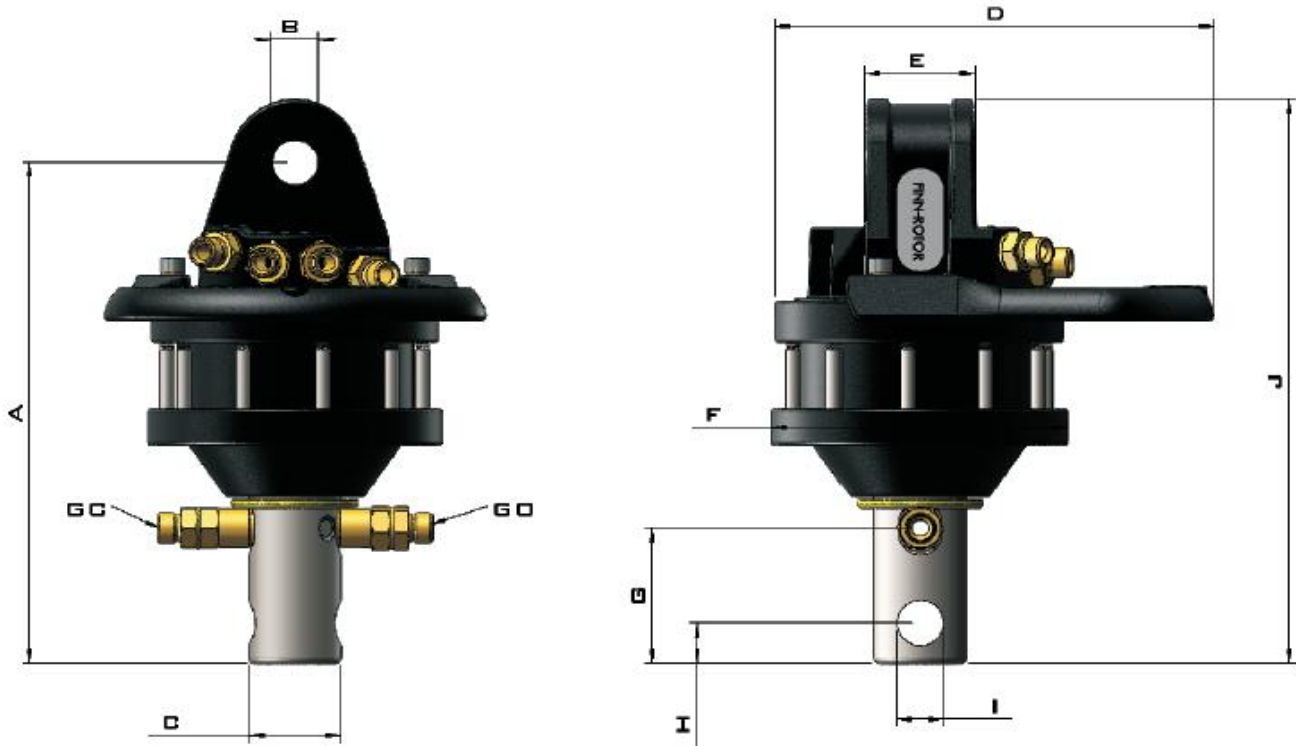

CR500A		
	mm	po (in)
A	311.0	12.244
B	30.0	1.181
C	69.0	2.717
D	266.0	10.472
E	73.0	2.874
F	184.0	7.244
G	91.5	3.602
H	32.0	1.260
I	30.0	1.181
J	351.0	13.819



CR600

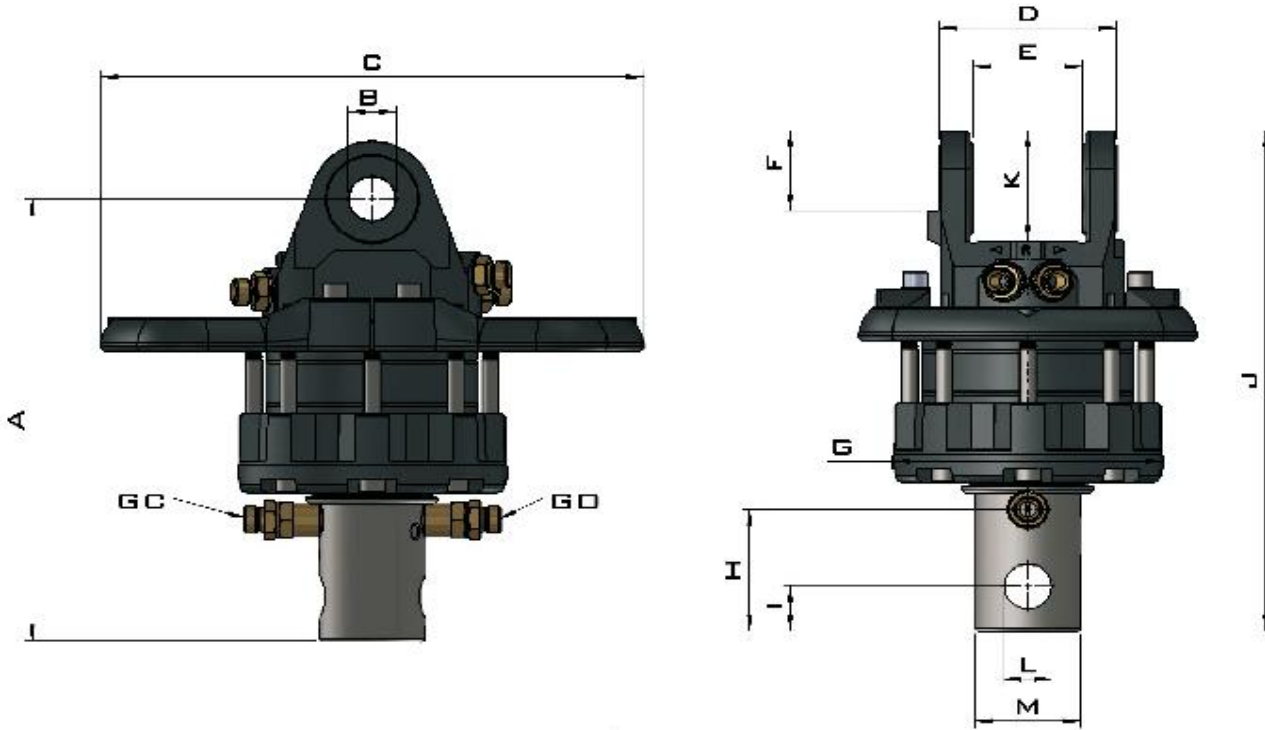

CR600 A78		
	mm	po (in)
A	346.0	13.622
B	35.0	1.378
C	400.0	15.748
D	130.5	5.138
E	80.5	3.169
F	62.5	2.461
G	198.0	7.795
H	95.0	3.740
I	35.0	1.378
J	359.0	15.354
K	87.0	3.425
L	35.0	1.378
M	78.0	3.071

CR300

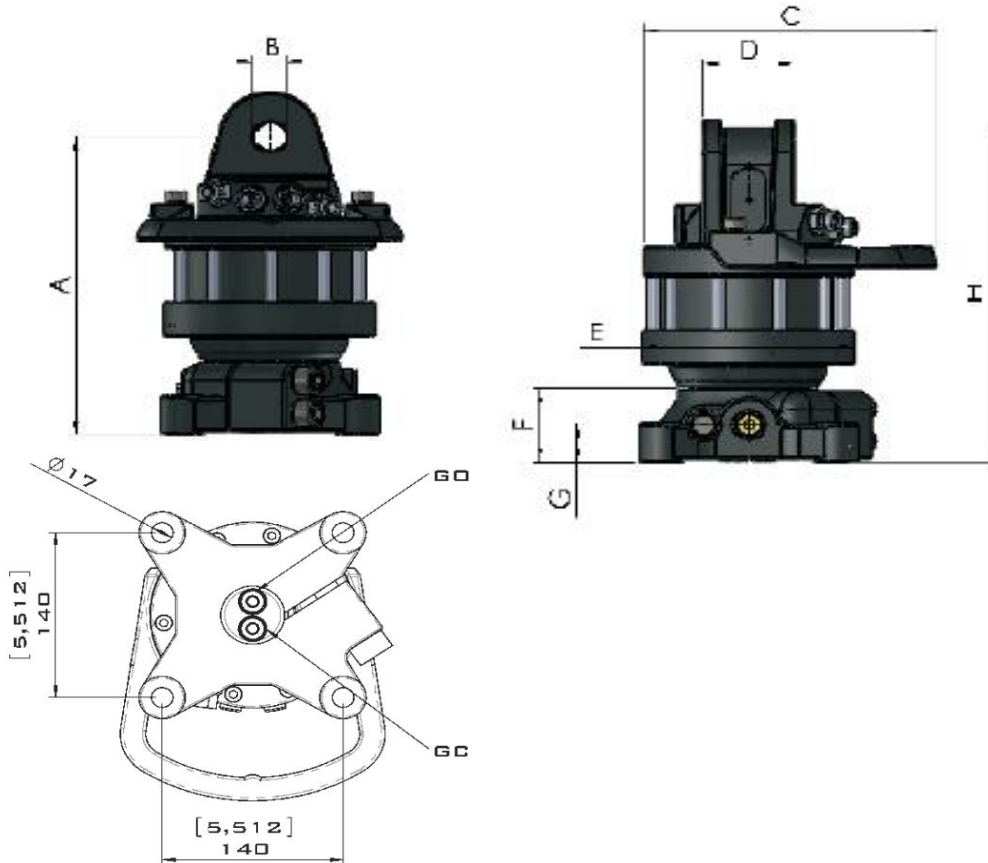

CR300 F140		
	mm	po (in)
A	232.0	9.134
B	25.0	0.984
C	234.0	9.213
D	60.0	2.362
E	158.0	6.220
F	46.0	1.811
G	30.0	1.181
H	267.0	10.512

CR304S F140		
	mm	po (in)
A	232.0	9.134
B	25.0	0.984
C	225.0	8.858
D	60.0	2.362
E	158.0	6.220
F	46.0	1.811
G	30.0	1.181
H	267.0	10.512

CR400

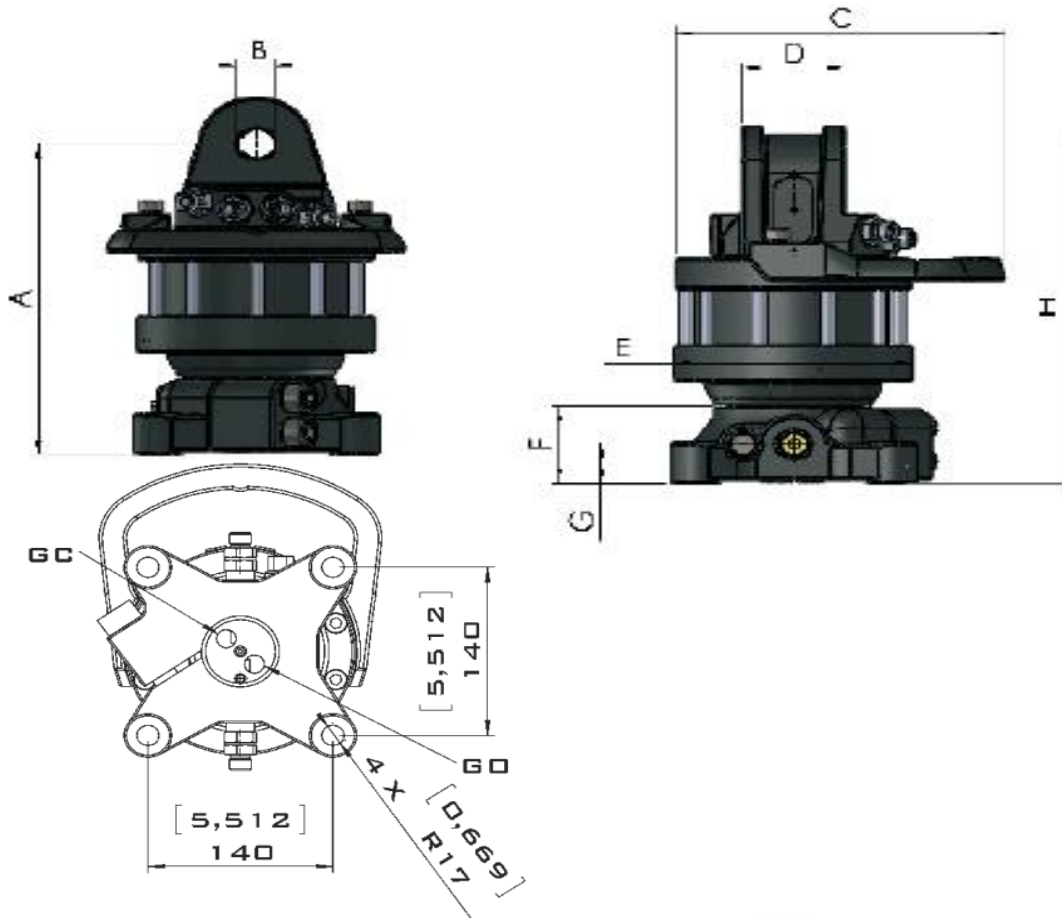

CR400 F140		
	mm	po (in)
A	246.0	9.665
B	25.0	0.984
C	241.0	9.488
D	73.0	2.362
E	172.0	6.772
F	46.0	1.811
G	30.0	1.181
H	286.0	11.260

CR404S F140		
	mm	po (in)
A	246.0	9.665
B	25.0	0.984
C	240.0	9.449
D	73.0	2.362
E	172.0	6.772
F	46.0	1.811
G	30.0	1.181
H	286.0	11.260

CR400

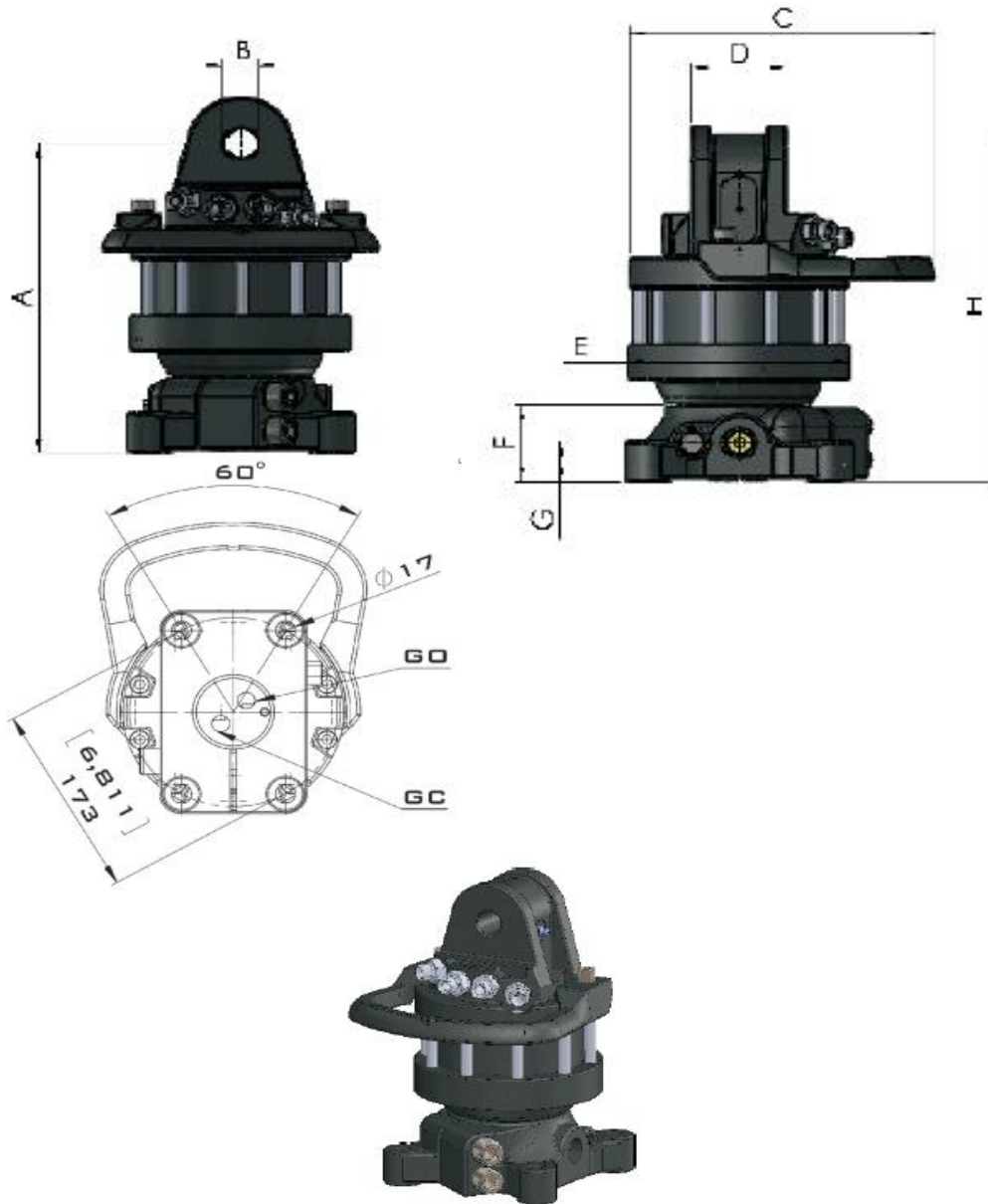

CR400 F140A68		
	mm	po (in)
A	273.0	10.748
B	25.0	0.984
C	241.0	9.488
D	73.0	2.362
E	172.0	6.772
F	67.0	2.638
G	35.0	1.378
H	305.0	12.008

CR400 F173A68		
	mm	po (in)
A	273.0	10.748
B	25.0	0.984
C	241.0	9.449
D	73.0	2.362
E	172.0	6.772
F	67.0	2.638
G	35.0	1.378
H	305.0	12.008

CR500

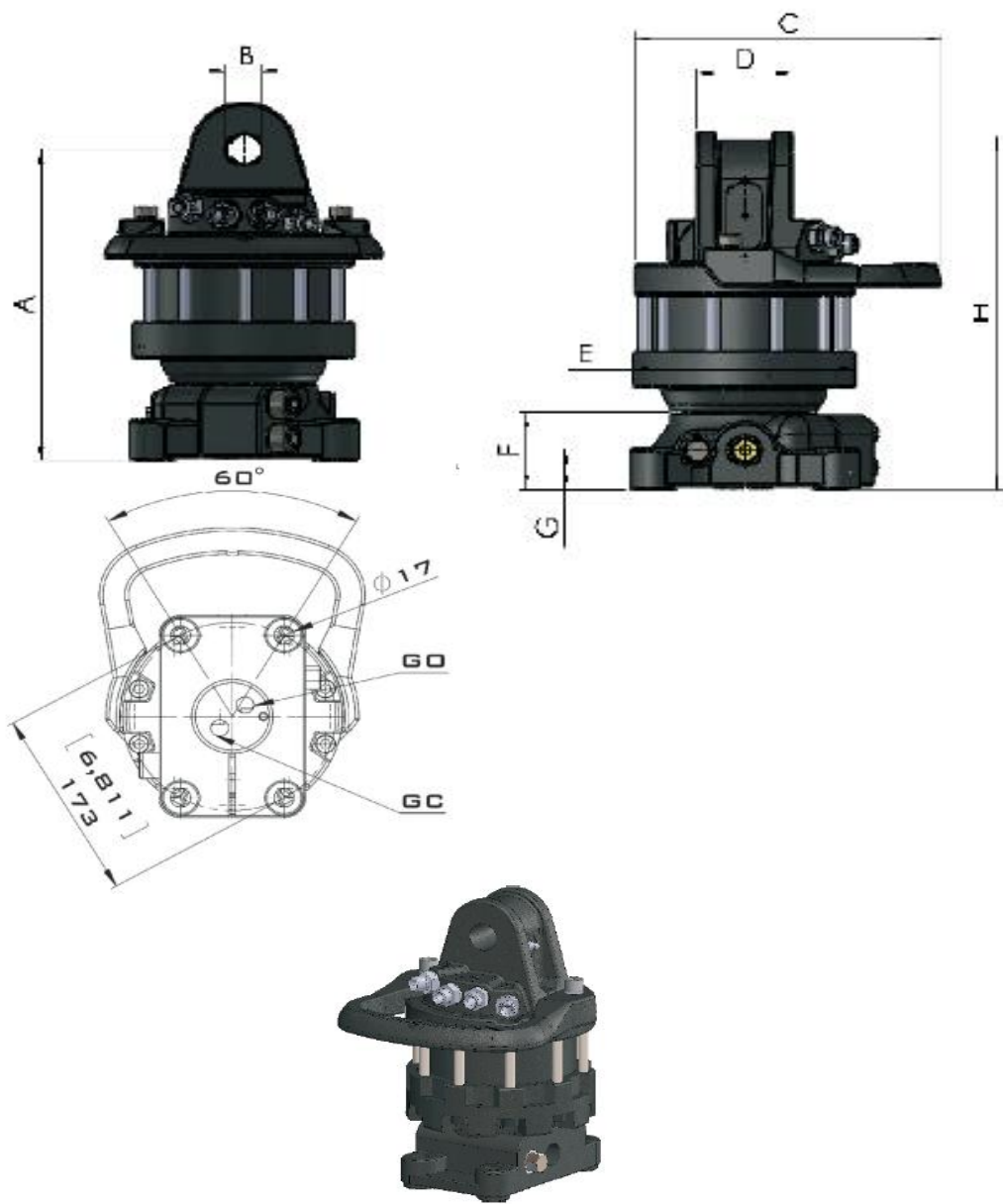

CR500 F140		
	mm	po (in)
A	273.0	10.748
B	30.0	1.181
C	234.0	10.472
D	73.0	2.874
E	184.0	7.244
F	67.0	2.677
G	35.0	1.378
H	313.0	12.323

CR500 F173		
	mm	po (in)
A	273.0	10.748
B	30.0	1.181
C	234.0	10.472
D	73.0	2.874
E	184.0	7.244
F	67.0	2.677
G	35.0	1.378
H	313.0	12.323

CR600

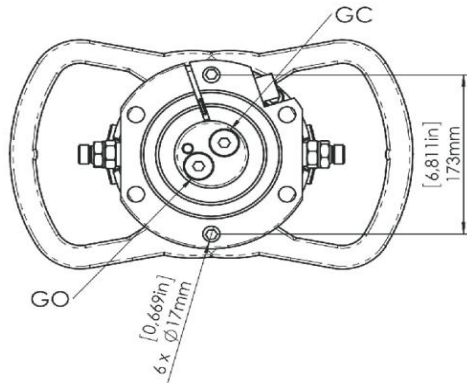
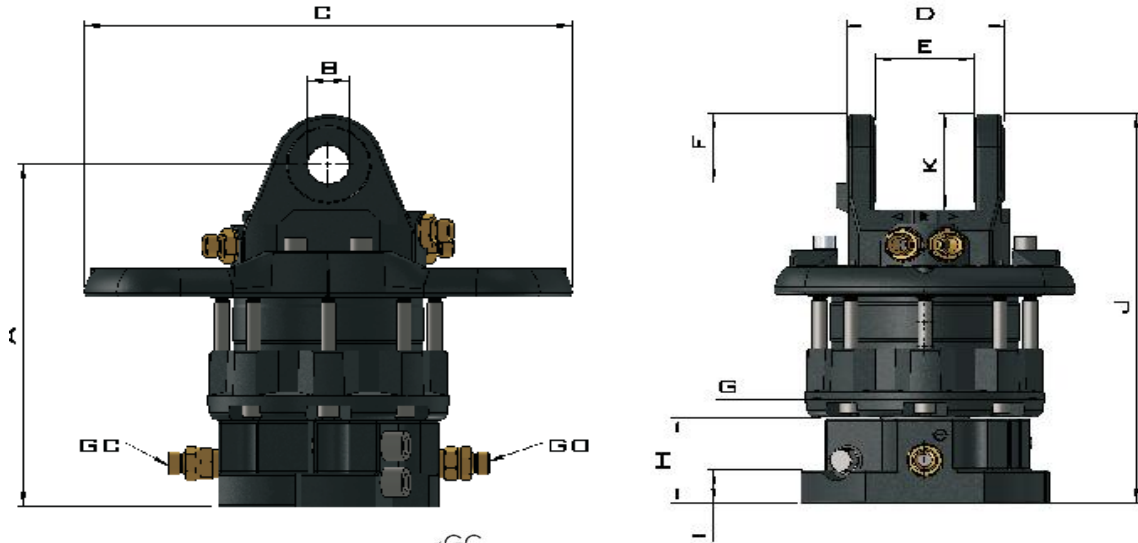

CR600 F173		
	mm	po (in)
A	308.0	12.126
B	35.0	1.378
C	400.0	15.748
D	130.5	5.138
E	80.5	3.169
F	62.5	2.461
G	198.0	7.795
H	77.0	3.031
I	30.0	1.181
J	353.0	13.898
K	87.0	3.425

CR600 B173		
	mm	po (in)
A	314.0	11.850
B	35.0	1.378
C	400.0	15.748
D	130.5	5.138
E	80.5	3.169
F	62.5	2.461
G	198.0	7.795
H	78.0	3.071
I	21.0	0.827
J	359.0	14.134
K	87.0	3.425

CR800 - CR1000

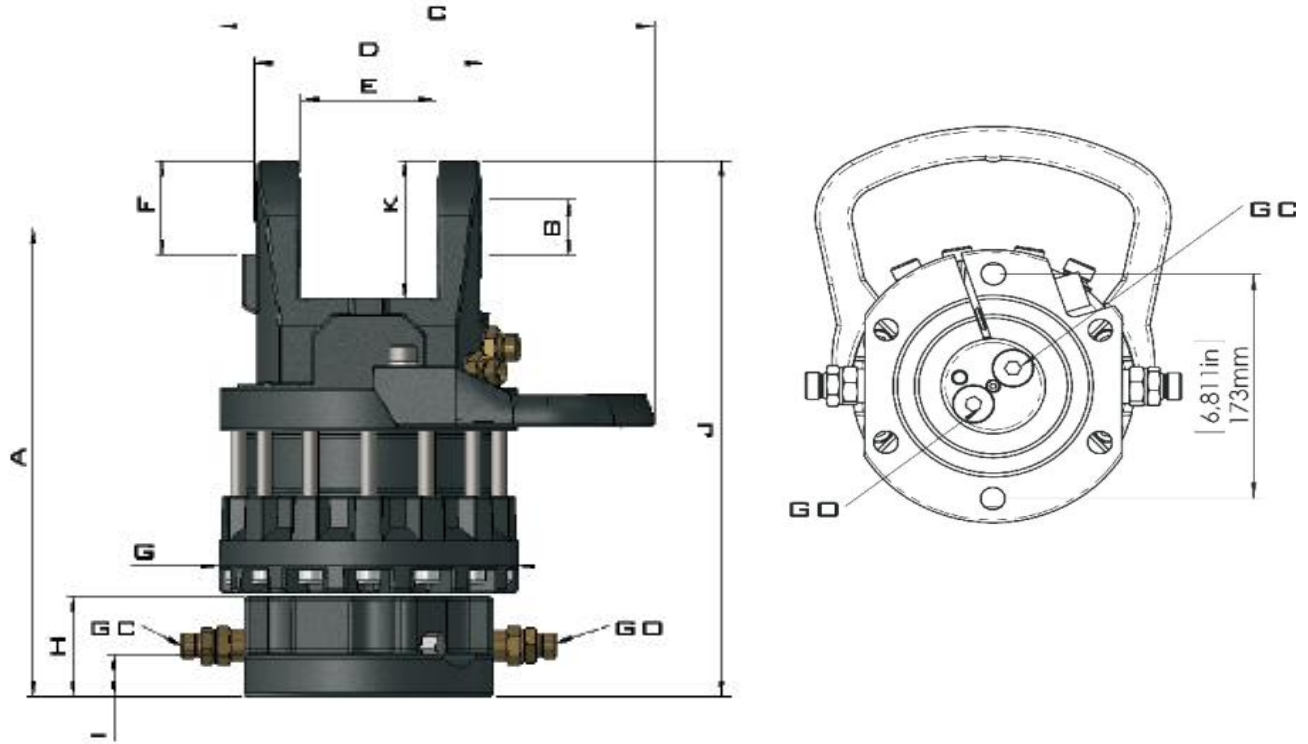

CRH W-MODEL

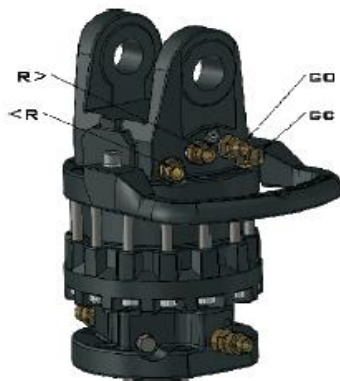

CRH X-MODEL

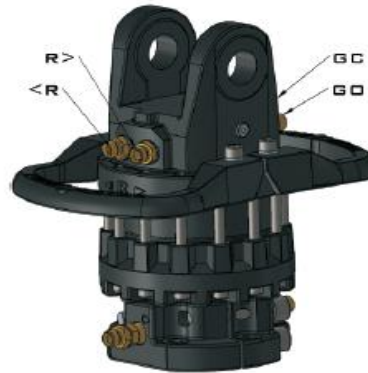

CR800H		
	mm	po (in)
A	308.0	12.126
B	35.0	1.378
C	298.0	11.721
D	130.5	5.138
E	80.5	3.169
F	62.5	2.461
G	198.0	7.795
H	77.0	3.030
I	30.0	1.181
J	353.0	13.898
K	87.0	3.425

CR1000H		
	mm	po (in)
A	350.5	13.799
B	35.0	1.378
C	314.0	12.362
D	130.5	5.138
E	80.5	3.169
F	62.5	2.461
G	214.0	8.425
H	79.0	3.110
I	30.0	1.181
J	395.5	15.571
K	87.0	3.425

CR1200 - CR1600

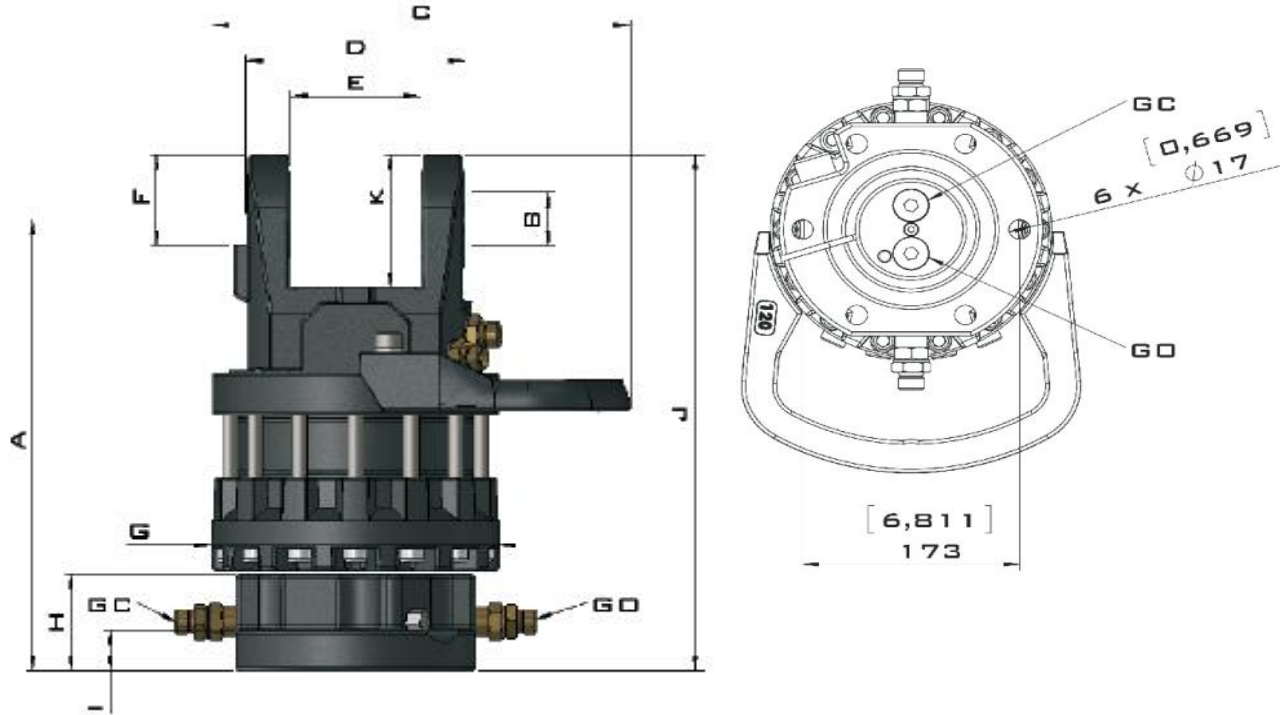

CRH W-MODEL

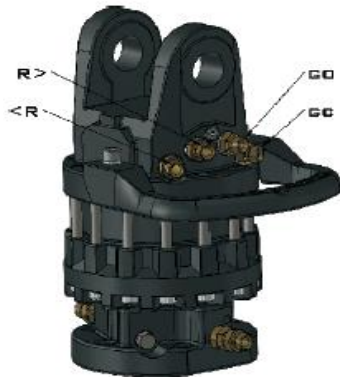

CRH X-MODEL

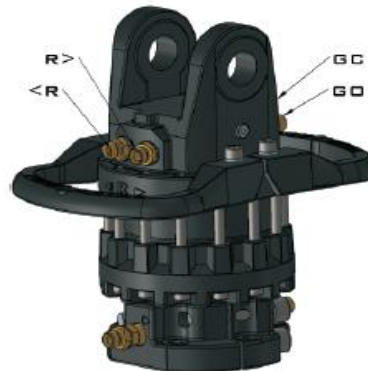

CR1200H		
	mm	po (in)
A	382.5	15.059
B	45.0	1.772
C	324.0	12.756
D	170.0	6.693
E	100.5	3.957
F	77.5	3.051
G	224.0	8.811
H	83.0	3.268
I	35.0	1.378
J	437.5	17.224
K	113.0	4.449

CR1600H		
	mm	po (in)
A	382.5	15.059
B	45.0	1.772
C	324.0	12.756
D	170.0	6.693
E	100.5	3.957
F	77.5	3.051
G	224.0	8.811
H	90.0	3.543
I	42.0	1.654
J	437.5	17.224
K	113.0	4.449



CR1200H-X45A35(D88)

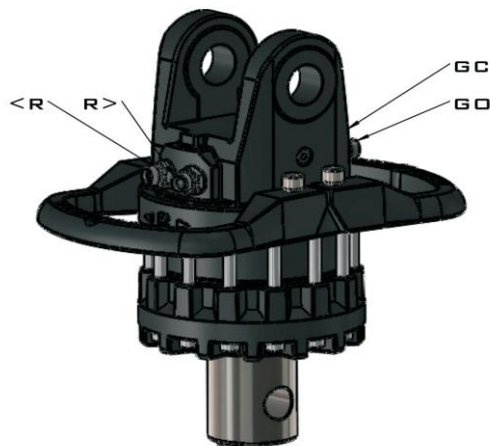
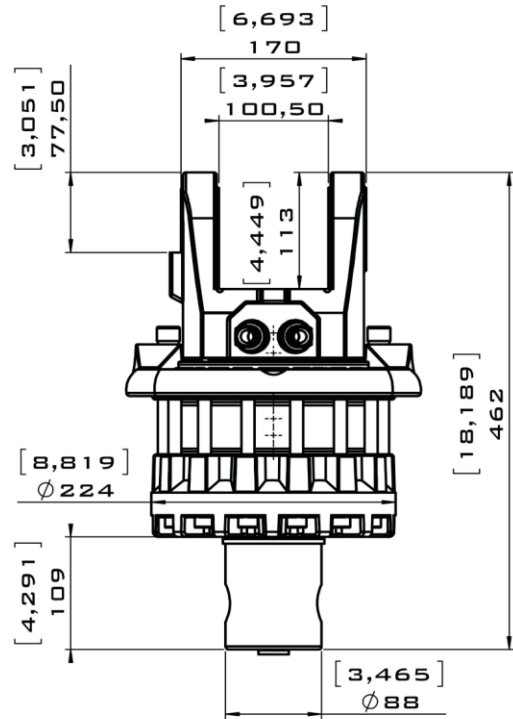
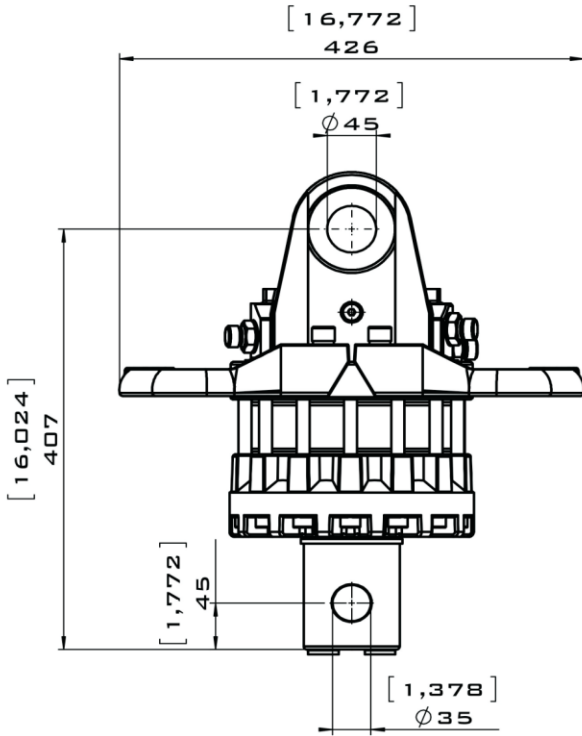

CR800 - CR1000

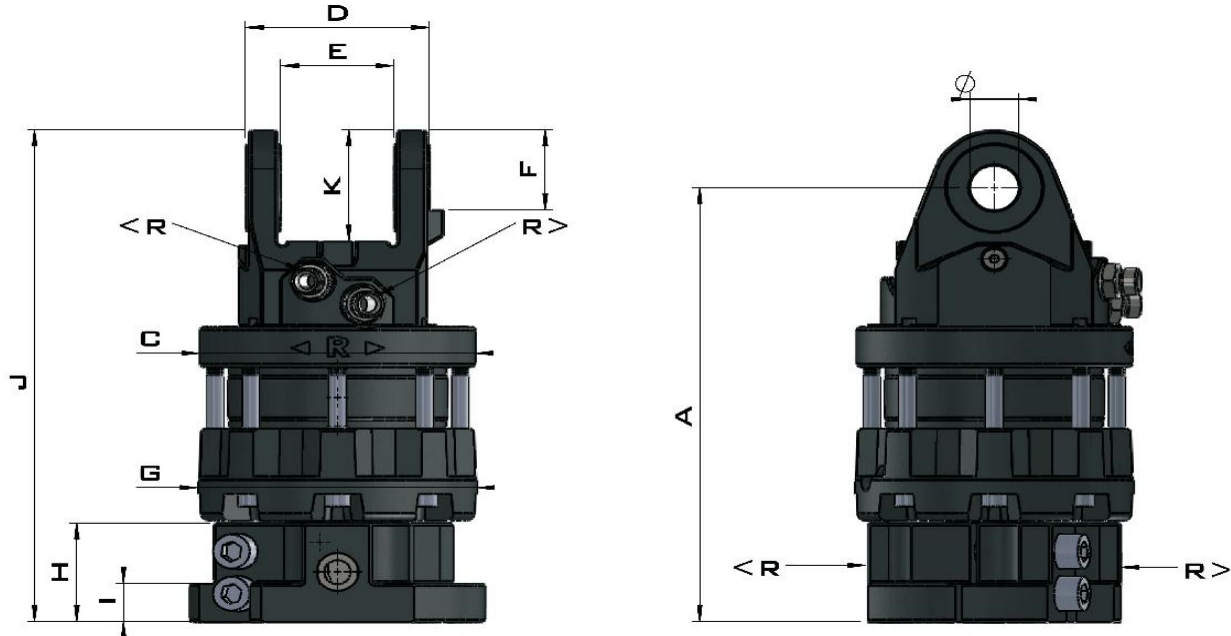

CR800M		
	mm	po (in)
A	308.0	12.126
B	35.0	1.378
C	196.0	7.717
D	130.5	5.138
E	80.5	3.169
F	62.5	2.461
G	198.0	7.795
H	77.0	3.030
I	30.0	1.181
J	353.0	13.898
K	87.0	3.425

CR1000M		
	mm	po (in)
A	350.5	13.799
B	35.0	1.378
C	212.0	8.346
D	130.5	5.138
E	80.5	3.169
F	62.5	2.461
G	214.0	8.425
H	79.0	3.110
I	30.0	1.181
J	395.5	15.571
K	87.0	3.425

CR1200 - CR1600

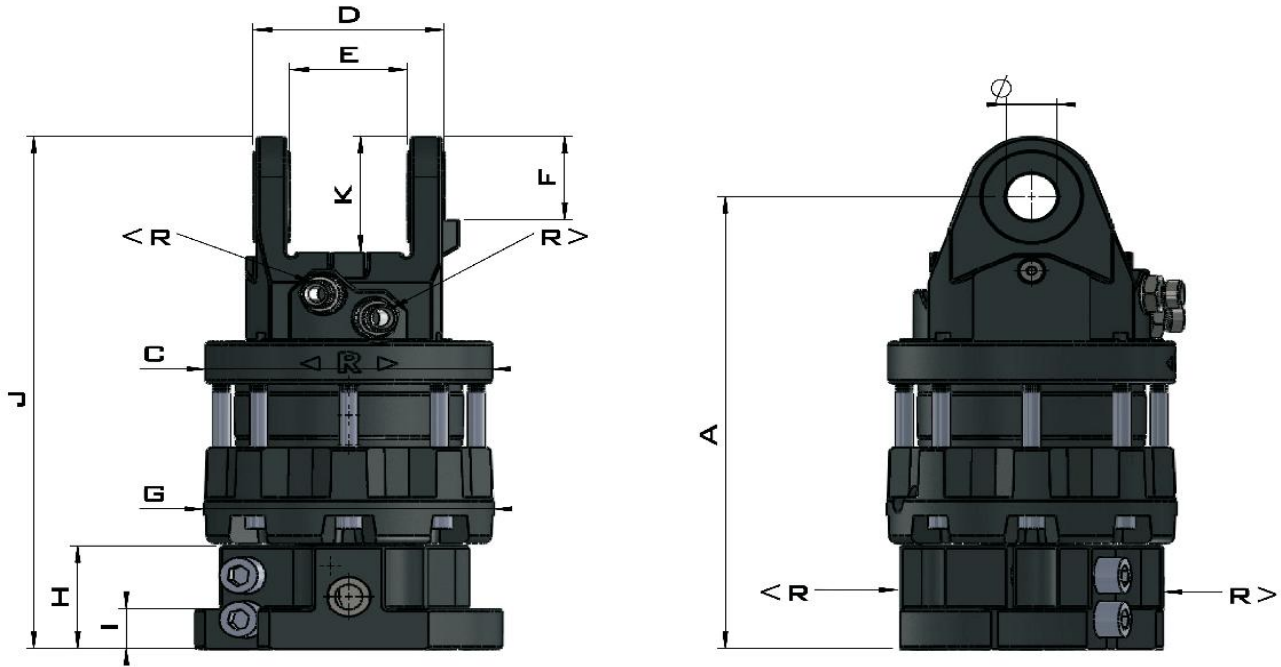

CR1200M		
	mm	po (in)
A	382.5	15.059
B	45.0	1.772
C	222.0	8.740
D	170.0	6.693
E	100.5	3.957
F	77.5	3.051
G	224.0	8.811
H	83.0	3.268
I	35.0	1.378
J	437.5	17.224
K	113.0	4.449

CR1600M		
	mm	po (in)
A	382.5	15.059
B	45.0	1.772
C	222.0	8.740
D	170.0	6.693
E	100.5	3.957
F	77.5	3.051
G	224.0	8.811
H	90.0	3.543
I	42.0	1.654
J	437.5	17.224
K	113.0	4.449

FR7

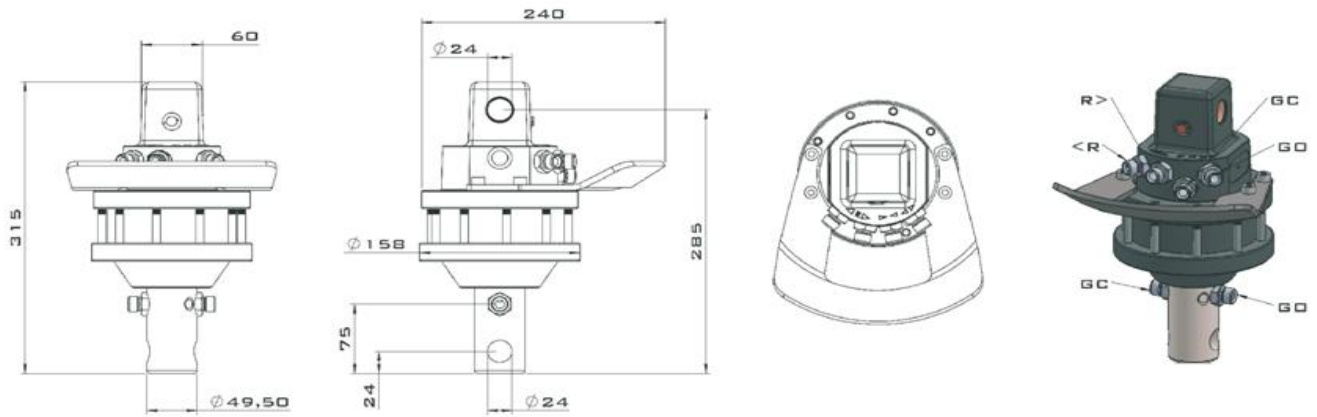

FR10

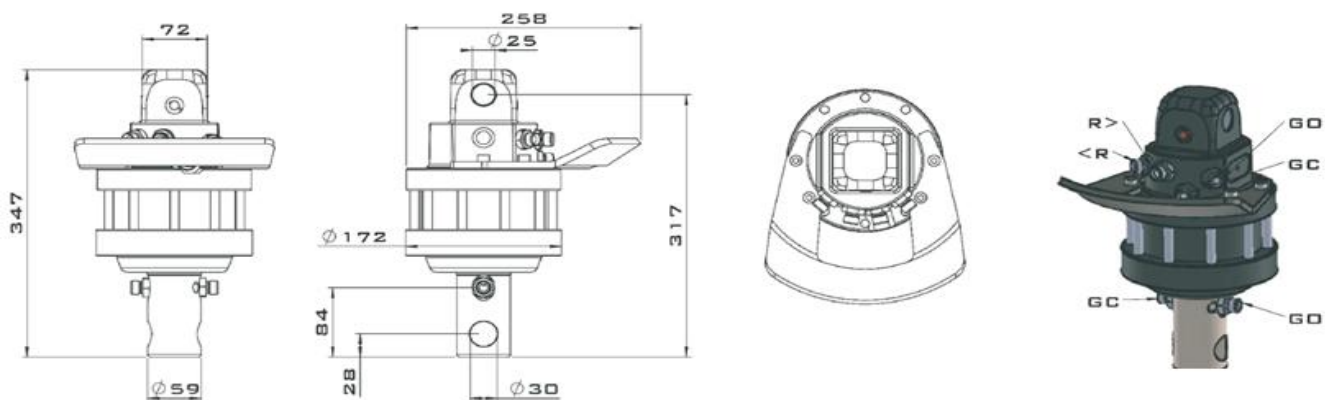

FR15

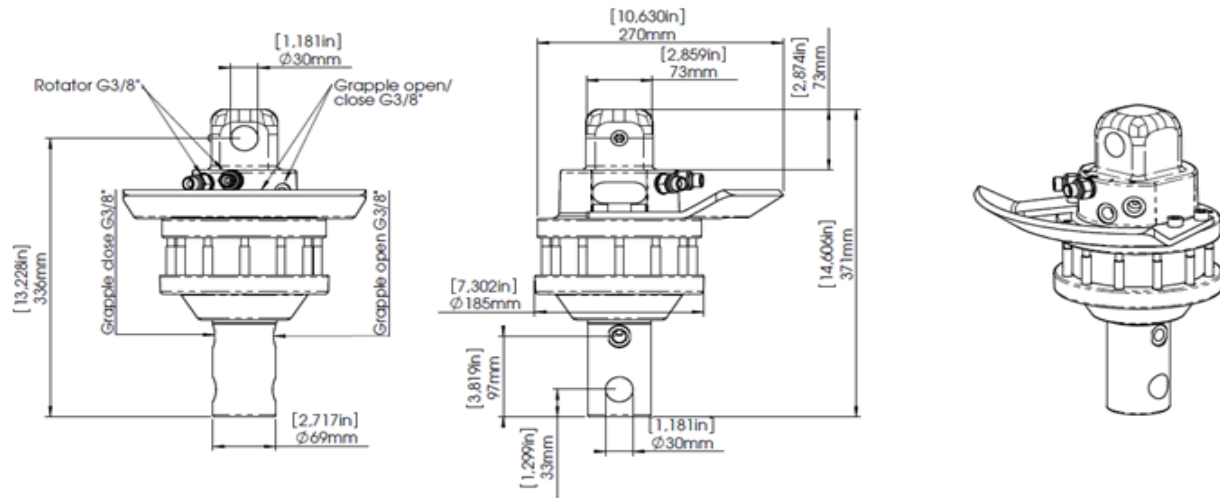

FR21

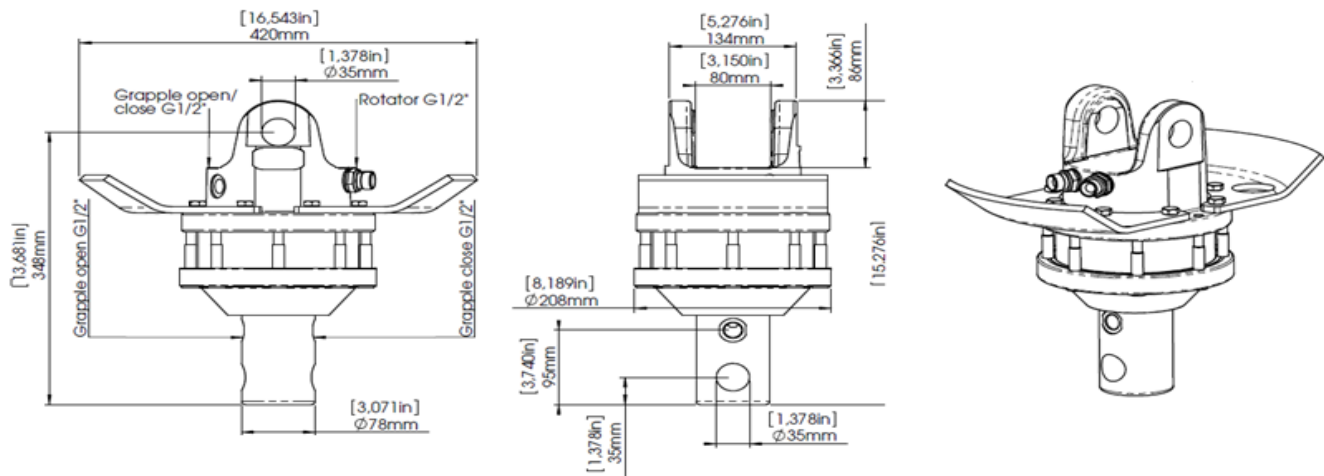

FR21-B

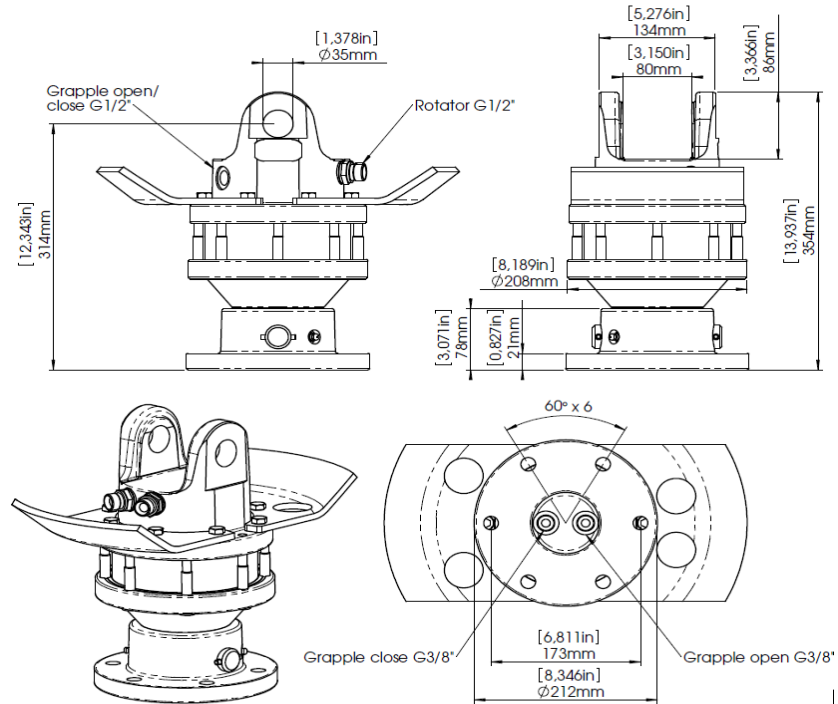

FR22-M

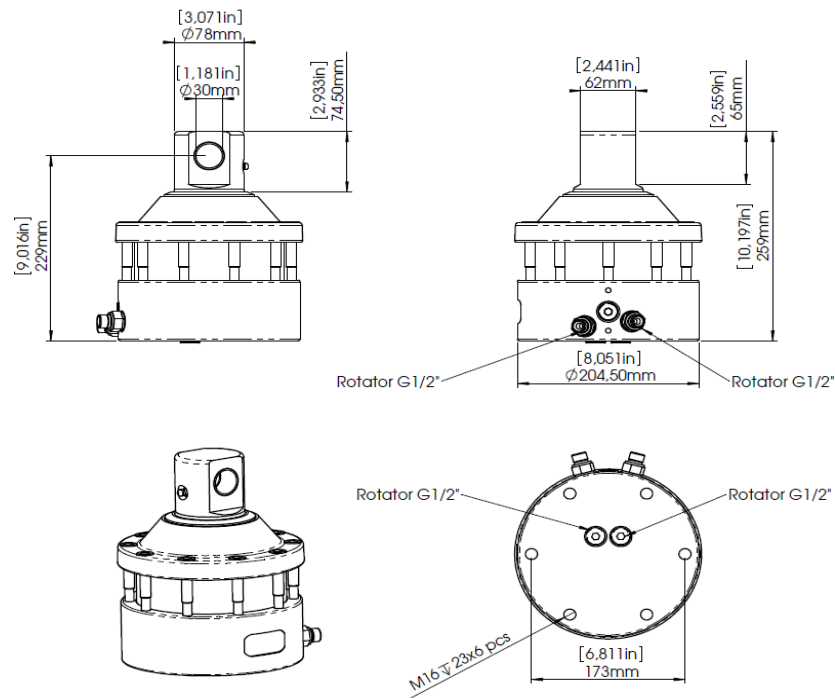

SÉRIE FR26 - SERIES FR26

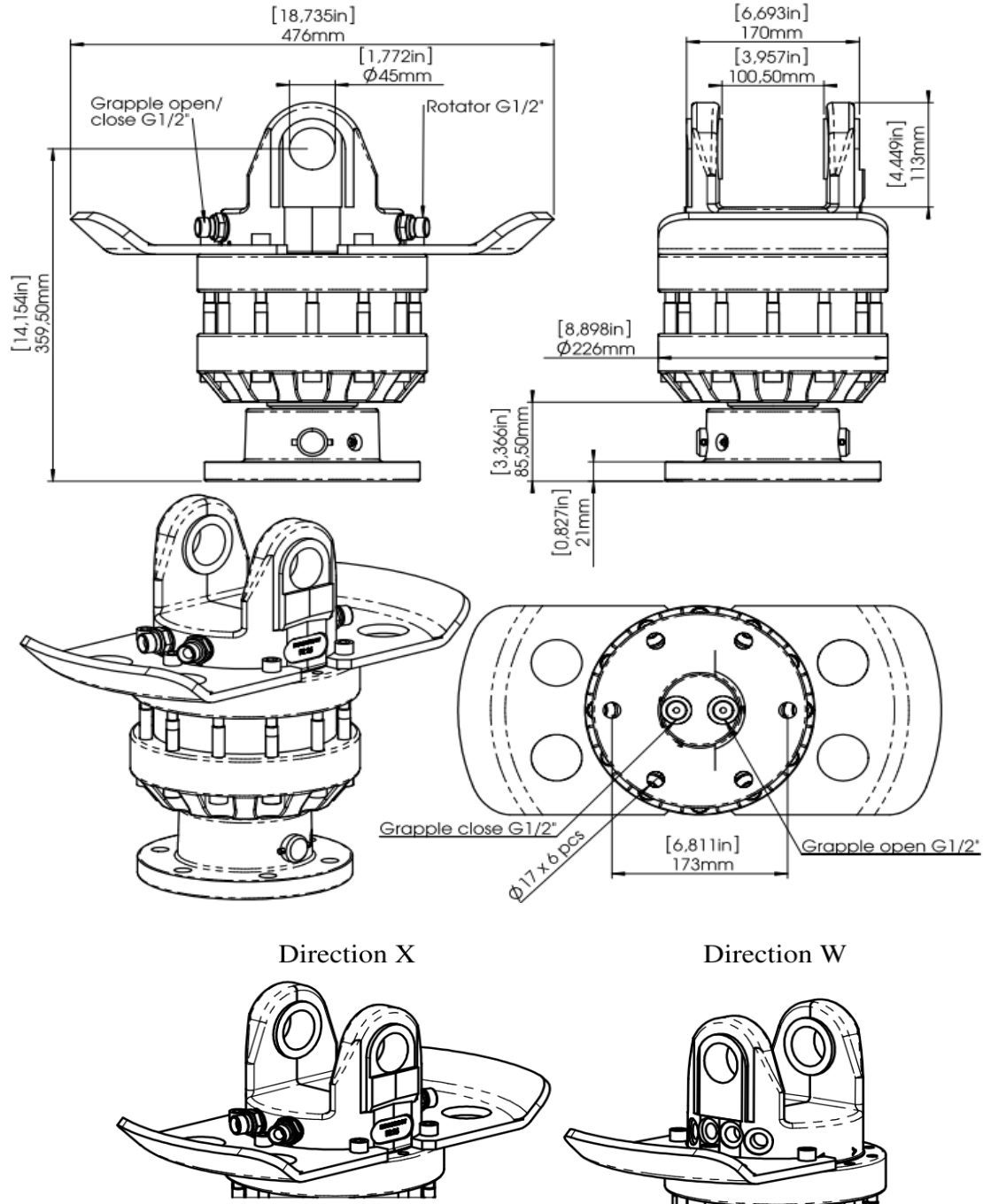

# | ACCESSOIRES - ACCESSORIES

## CL - CBL - CDBL

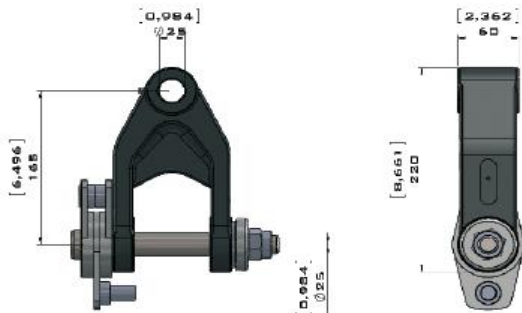

Série/Series	Rotateur/Rotator
CL 7325-6025	300,400
CBL 7325-6025	300,400

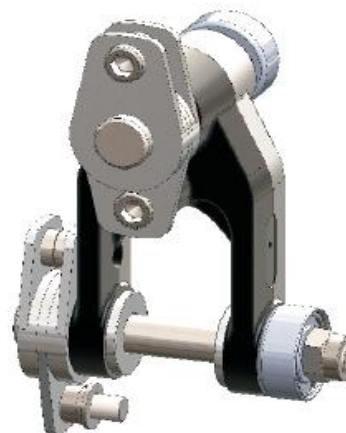
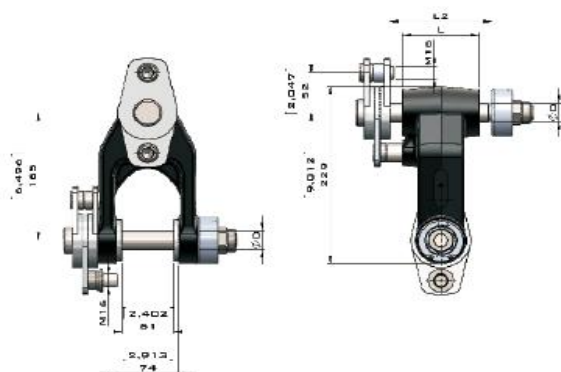

Série/Series	Rotateur/Rotator	D	L	D2
CL 7325-8025	300,400	25	80	110
CBL 7325-8025	300,400	25	80	110
CDBL 7325-8025	300,400	25	80	110
CL 7330-8030	500	30	80	110
CBL 7330-8030	500	30	80	110
CDBL 7330-8030	500	30	80	110
CL 7325-9025	300,400	25	90	120
CBL 7325-9025	300,400	25	90	120
CDBL 7325-9025	300,400	25	90	120
CL 7330-9030	500	30	90	120
CBL 7330-9030	500	30	90	120
CDBL 7330-9030	500	30	90	120



# ACCESSOIRES - ACCESSORIES

## CBLA

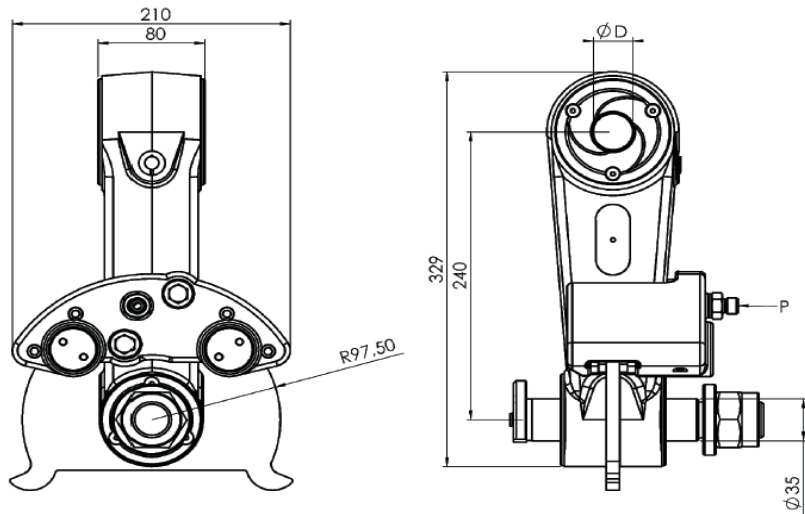

Série/Series	Rotateurs/Rotators	D (mm)
CLBA 80	600 800H 800M 1000M	30,35,40,45

## AMORTISSEUR POUR FR - SWING DAMPER FOR FR

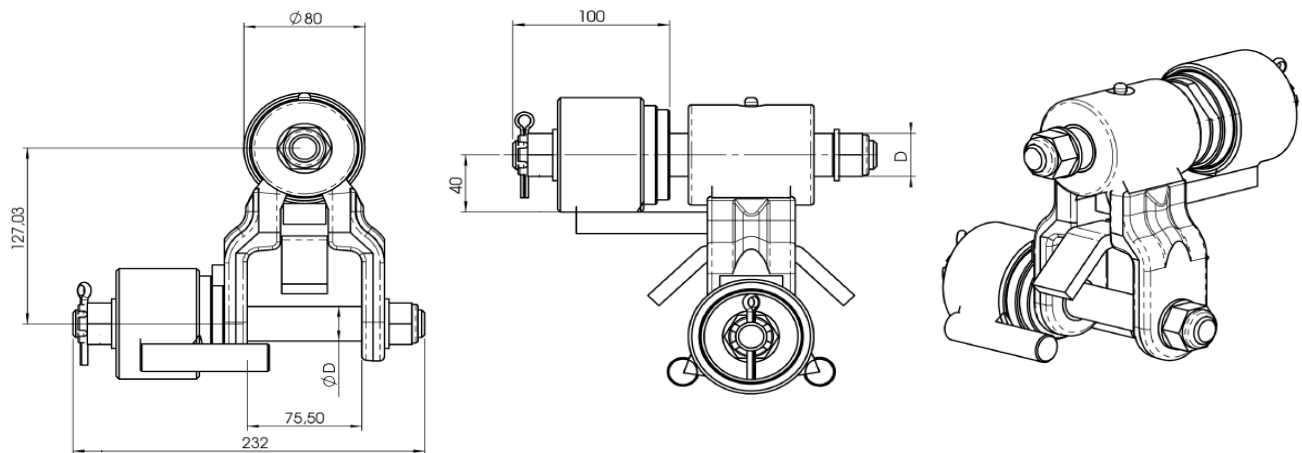

Série/Series	Rotateurs/Rotators	D (mm)
Amortisseur Swing damper	FR 7	24
	FR 10	25
	FR 15	30

# ACCESSOIRES - ACCESSORIES

## JOINT TYPE O POUR FR - O TYPE JOINT FOR FR

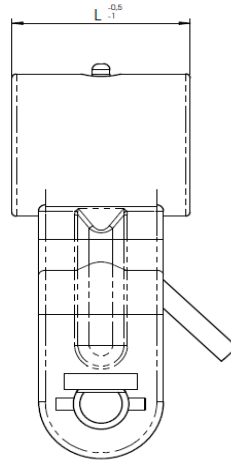
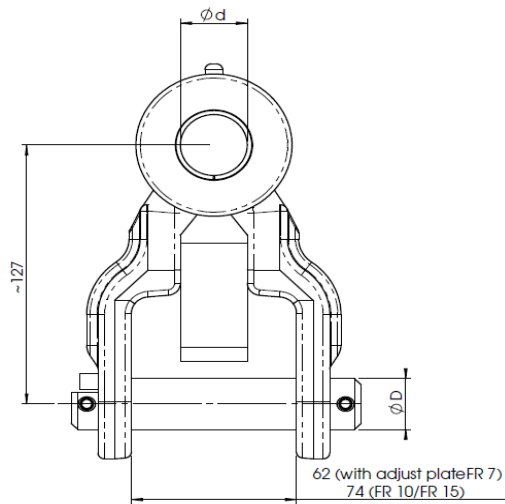

Modèles de rotateur Rotator models	Série Series	DD
FR 7	07	24
FR 7	07	25
FR 10	10	25
FR 15	15	30

d	L											
	35	40	45	50	55	60	65	70	80	90	100	120
20	d20L35	d20L40	d20L45	d20L50	d20L55	d20L60	d20L65	d20L70	d20L80	d20L90	d20L100	d20L120
25	d25L35	d25L40	d25L40	d25L50	d25L55	d25L60	d25L65	d25L70	d25L80	d25L90	d25L100	d25L120
28	d28L35	d28L40	d28L47	d28L50	d28L55	d28L60	d28L65	d28L70	d28L80	d28L90	d28L100	d28L120
30	d30L35	d30L40	d30L48	d30L50	d30L55	d30L60	d30L65	d30L70	d30L80	d30L90	d30L100	d30L120
35	d35L35	d35L40	d35L49	d35L50	d35L55	d35L60	d35L65	d35L70	d35L80	d35L90	d35L100	d35L120
40	d40L35	d40L40	d40L50	d40L50	d40L55	d40L60	d40L65	d40L70	d40L80	d40L90	d40L100	d40L120
45	d45L35	d45L40	d45L51	d45L50	d45L55	d45L60	d45L65	d45L70	d45L80	d45L90	d45L100	d45L120

Exemple/Example Code rotateur/ Rotator code	D	d	L	Item	Modèle Model
7	24	28	50	07242850	Link O FR7-D24d28L50

# ACCESSOIRES - ACCESSORIES

## JOINT TYPE I POUR FR - I TYPE JOINT FOR FR

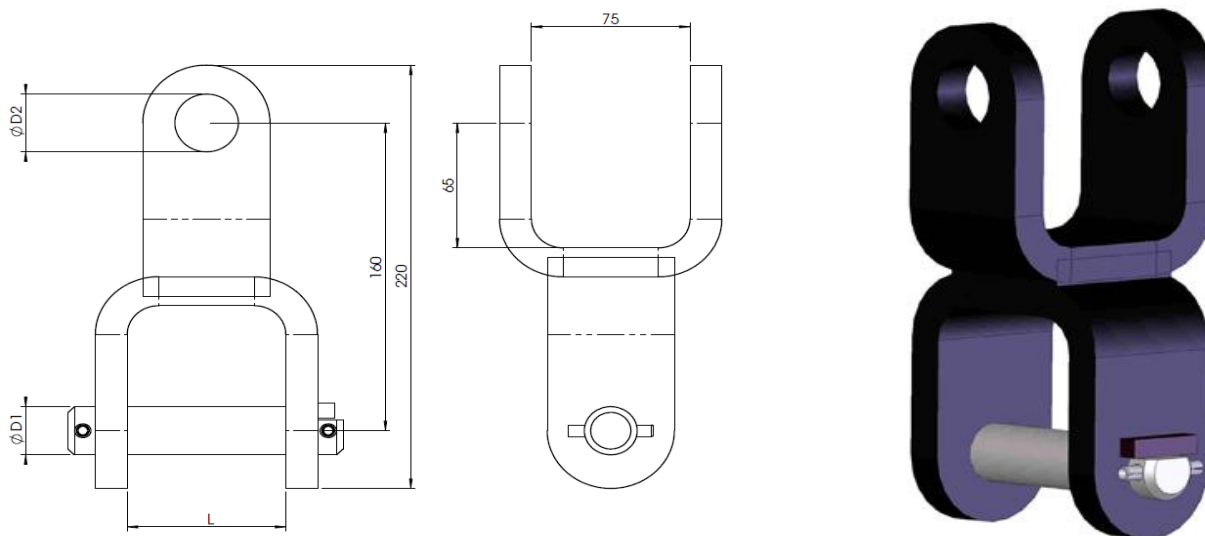

Modèles de base Basic models				
Item	Série/Series	D1	D2	L
00877	Lien/Link FR7 Id25x75 + Pin 24	24	25	75
00874	Lien/Link FR7 Id25x75 + Pin 25	25	25	75
00878	Lien/Link FR7 Id30x75 + Pin 24	24	30	75
00876	Lien/Link FR7 Id30x75 + Pin 25	25	30	75
01097	Lien/Link FR10 Id25x75 + Pin 25	25	25	75
01090	Lien/Link FR10 Id30x75 + Pin 25	25	30	75
01598	Lien/Link FR15 Id30x75 + Pin 30	30	30	75

## SÉRIE DEMI-LIEN - HALFLINK SERIES

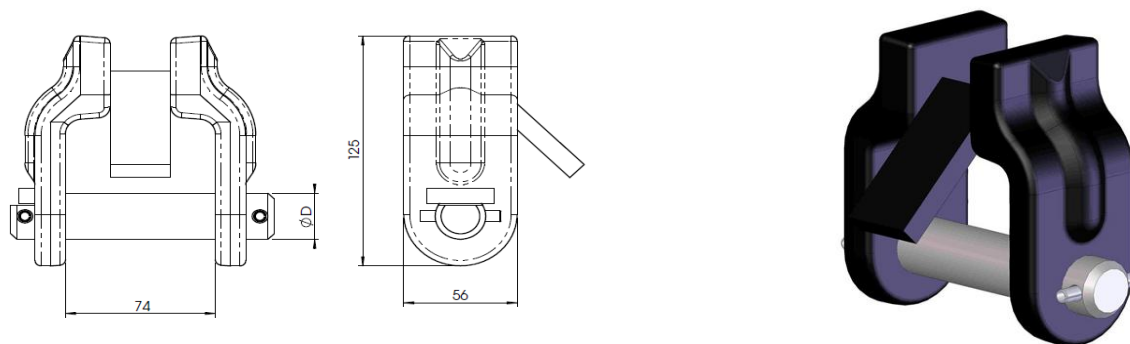

Modèles de base Basic models			
Item	Série/Series	D	L
00741	Lien/Link FR7 1/2 d24	24	62
00740	Lien/Link FR7 1/2 d25	25	62
01107	Lien/Link FR10 1/2 d25	25	74
01109	Lien/Link FR10 1/2 d26	26	74
01583	Lien/Link FR15 1/2 d30	30	74

# ACCESSOIRES - ACCESSORIES

## SÉRIE FLASQUE BM - FLANGE BM SERIES

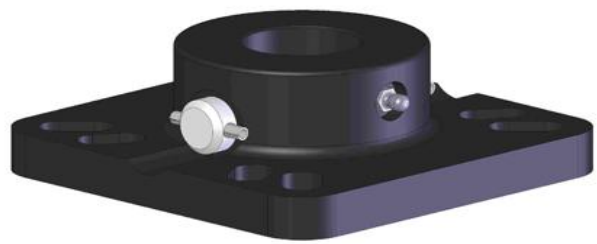
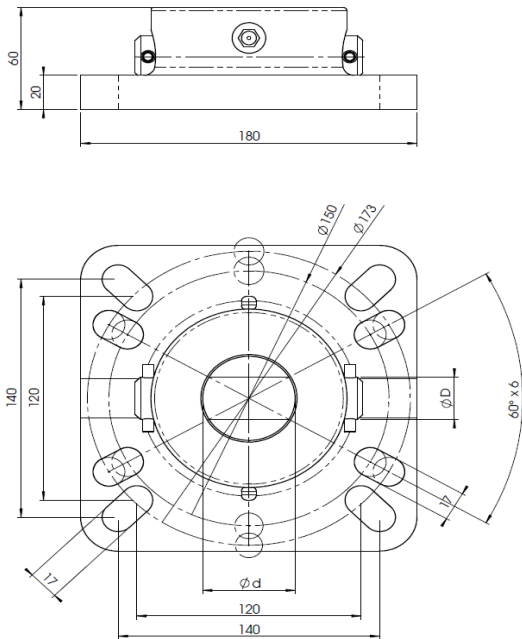

Modèles de base Basic models				Connexions Connections			
Item	Série/Series	D	d	120x120	140x140	6x150	6x173
00884	Flasque/Flange FR 7 BMd24	24	49.5	x	x	x	x
00893	Flasque/Flange FR 7 BMd25	25	49.5	x	x	x	x
00896	Flasque/Flange FR 10 BMd25	25	59.0	x	x	x	x
00888	Flasque/Flange FR 10 BMd30	30	59.0	x	x	x	x
00889	Flasque/Flange FR 15 BMd30	30	69.0	x	x	x	

## SÉRIE FLASQUE B150 - FLANGE B150 SERIES

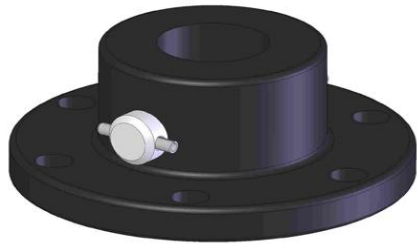
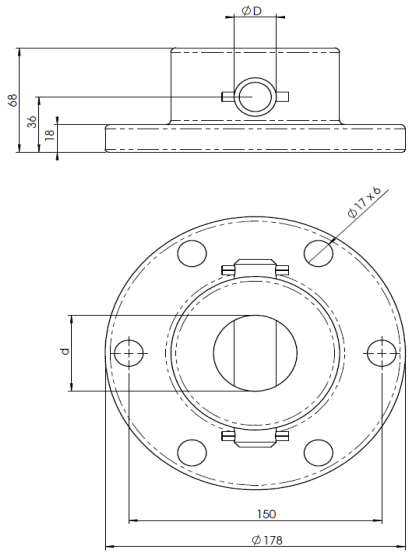

Modèles de base Basic models				
Item	Série/Series	D	d	Flasque/Flange
00891	Flasque/Flange FR 7 B150d24	24	49.5	B150
00890	Flasque/Flange FR 7 B150d25	25	49.5	B150
00892	Flasque/Flange FR 7 B150d26	26	49.5	B150
01392	Flasque/Flange FR 10 B150d25	25	59.0	B150
01391	Flasque/Flange FR 10 B150d26	26	59.0	B150
01390	Flasque/Flange FR 10 B150d30	30	59.0	B150

# ACCESSOIRES - ACCESSORIES

## SÉRIE FLASQUE B173 - FLANGE B173 SERIES

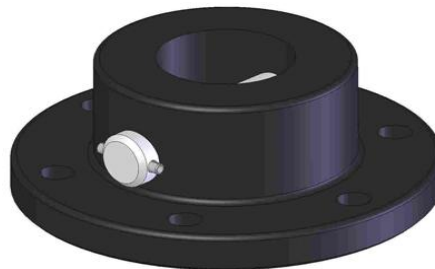
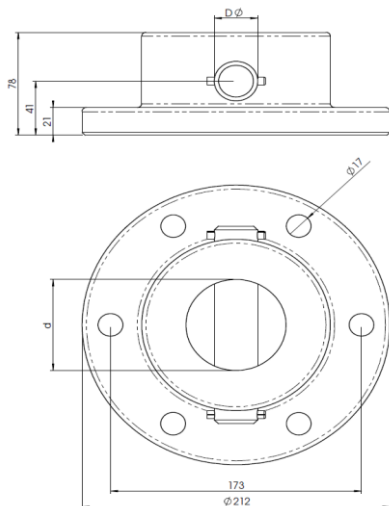

Modèles de base Basic models				
Item	Série/Series	D	d	Flasque/Flange
01394	Flasque/Flange FR 10 B173d25	25	59	B173
01395	Flasque/Flange FR 10 B173d30	30	59	B173
01575	Flasque/Flange FR 15 B173d30	30	69	B173
02039	Flasque/Flange FR 21 B173d30	30	78	B173
02038	Flasque/Flange FR 21 B173d35	35	78	B173

## CROCHET À GRAPIN - LIFTING HOOK

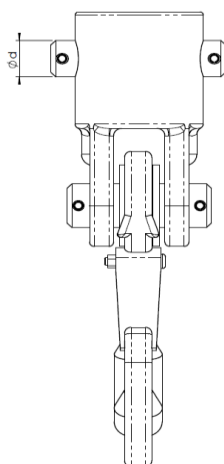
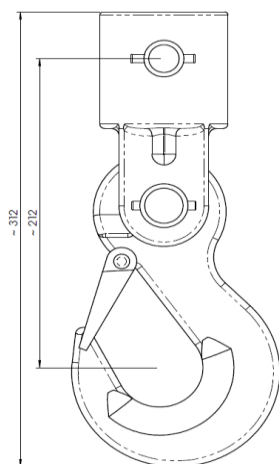

Modèles de base Basic models		
Item	Série/Series	d
00901	Grappin/Lifting hook FR 7 d24	24
00899	Grappin/Lifting hook FR 7 d25	25
01350	Grappin/Lifting hook FR 10 d25	25
01351	Grappin/Lifting hook FR 10 d30	30
01579	Grappin/Lifting hook FR 15 d30	30

# | ACCESSOIRES - ACCESSORIES

## BAGUE SOUDABLE - WELDING HOUSING

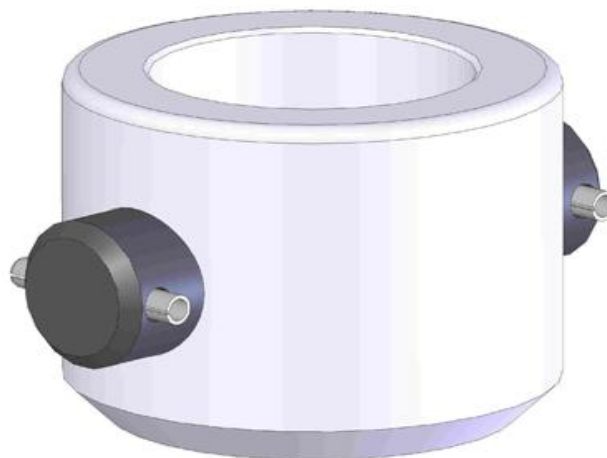
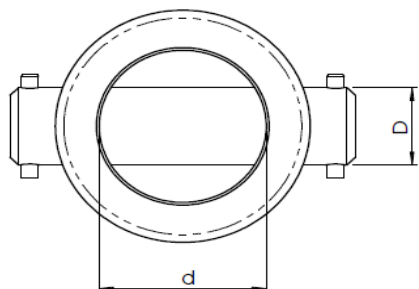
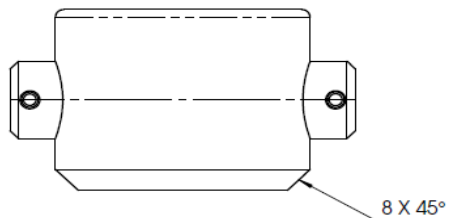

Modèles de base Basic models			
Item	Série/Series	D	d
00722	Bague soudable/Welding housing FR 7 D24	24	49.5
00721	Bague soudable/Welding housing FR 7 D25	25	49.5
01121	Bague soudable/Welding housing FR 10 D25	25	59.0
01101	Bague soudable/Welding housing FR 10 D30	30	59.0
01581	Bague soudable/Welding housing FR 15 D30	30	69.0
02035	Bague soudable/Welding housing FR 21 D30	30	78.0
02037	Bague soudable/Welding housing FR 21 D35	35	78.0

CR100

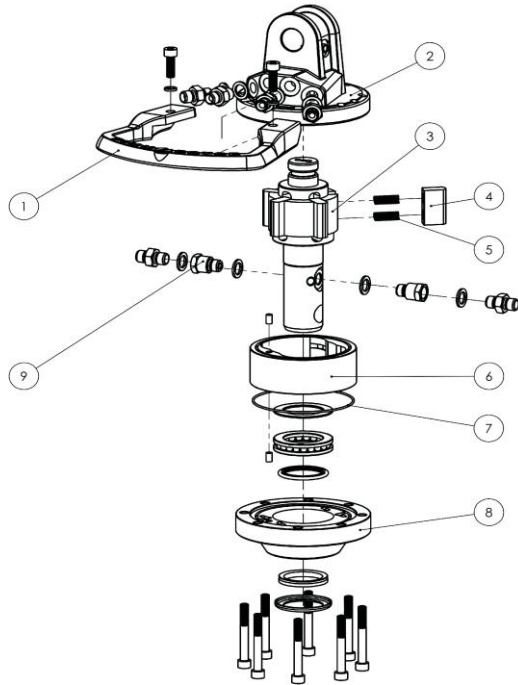

Description	Code Canimex	Code Fournisseur
1. Garde tuyau/Hose guard	-	S70100-HG
2. Couvert supérieur W25 Upper cover W25	-	S70100-UC
3. Kit de réparation d'arbre A25/Shaft repair kit A25	-	S70100-SH
4. Ailettes/Wing kit	CR100 (Wing kit)	S70100-WI
5. Kit de ressort/Spring kit	CR100 (Spring kit)	S70100-SP
6. Stator	-	S70100-ST
7. Jeu de joints/Seal kit	SK CR100	S70100-SE
8. Couvert inférieur/Lower cover Boulons de côté/Sidebolts M8x65 12.9 (8pcs) Boulons du garde tuyau/Hose guard bolts M8x30 (2pcs)	-	S70100-LC

CR300A

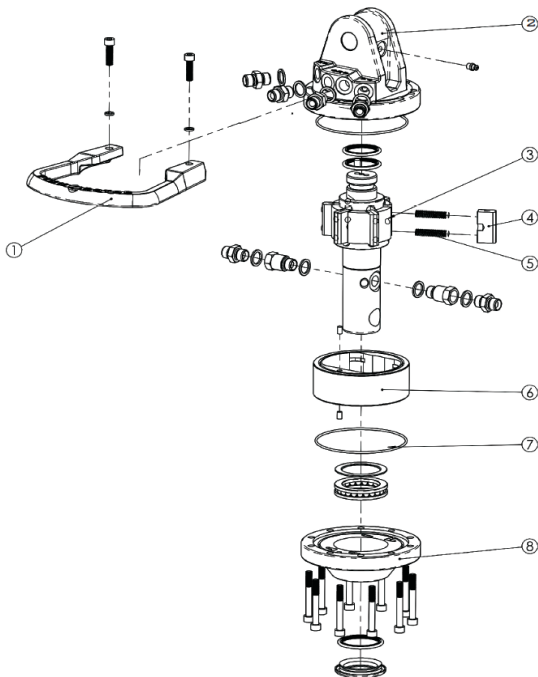

Description	Code Canimex	Code Fournisseur
1. Garde tuyau/Hose guard	CR300 (Hose guard)	S70300-HG
2. Couvert supérieur W25 Upper cover W25	-	S70300-UC
3. Kit de réparation d'arbre A25/Shaft repair kit A25	-	S70300-SH
4. Ailettes/Wing kit	CR300 (Wing kit)	S70300-WI
5. Kit de ressort/Spring kit	CR300 (Spring kit)	S70300-SP
6. Stator	-	S70300-ST
7. Jeu de joints/Seal kit	SK CR300	S70300-SE
8. Couvert inférieur/Lower cover Boulons de côté/Sidebolts M8x65 12.9 (10pcs) Boulons du garde tuyau/Hose guard bolts M8x30 (2pcs)	-	S70300-LC

CR300F

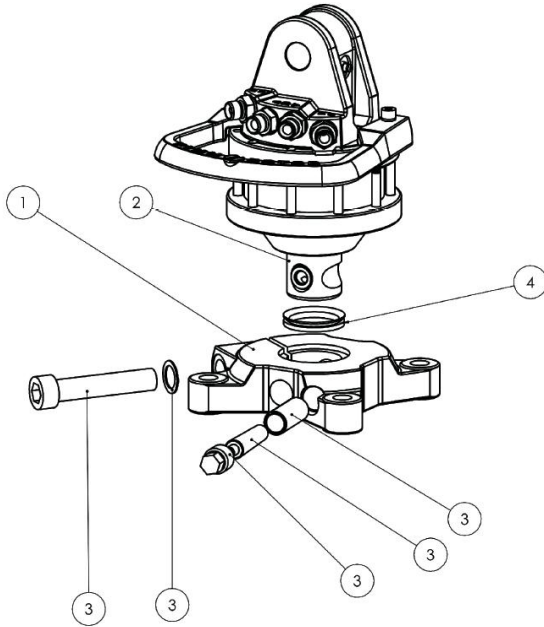

Description	Code Canimex	Code Fournisseur
1. Flasque/Flange CR300 F140	-	S70300-FL
2. Kit de réparation d'arbre F140/Shaft repair kit F140	-	S70300-SF
3. Kit de connexion flasque Flange connection kit	-	S70300-FC
4. Joint de la flasque Flange seal	-	S70300-FS

CR400A

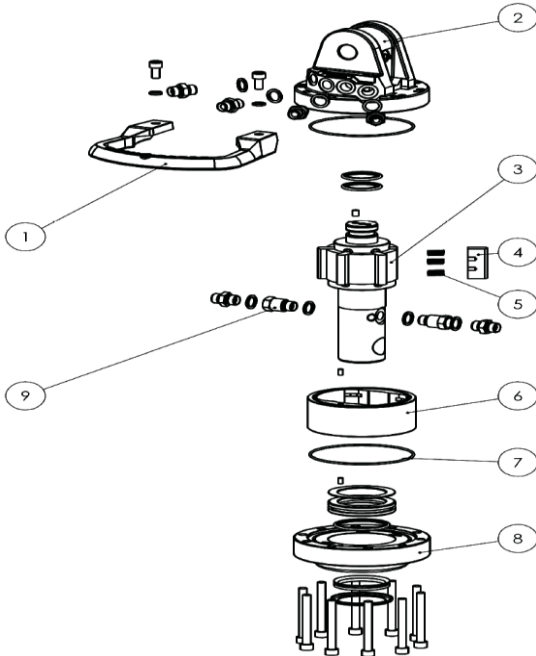

Description	Code Canimex	Code Fournisseur
1. Garde tuyau/Hose guard	-	S70400-HG
1. Garde tuyau en acier Steel hose guard	-	S70404-HG
2. Couvert supérieur W25 Upper cover W25	-	S70400-UC
3. Kit de réparation d'arbre A30/Shaft repair kit A30	-	S70400-SH
4. Ailettes/Wing kit	CR400 (Wing kit)	S70400-WI
5. Kit de ressort/Spring kit	CR400 (Spring kit)	S70400-SP
6. Stator	-	S70400-ST
7. Jeu de joints/Seal kit	SK CR400	S703400-SE
8. Couvert inférieur Lower cover	-	S70400-LC
9. Raccord allongé/Extension nipple CR400 G3/8" Boulons de côté/Sidebolts M10x90 12.9 (10pcs) Boulons du garde tuyau/Hose guard bolts M10x30 (2pcs)	-	-



CR400F

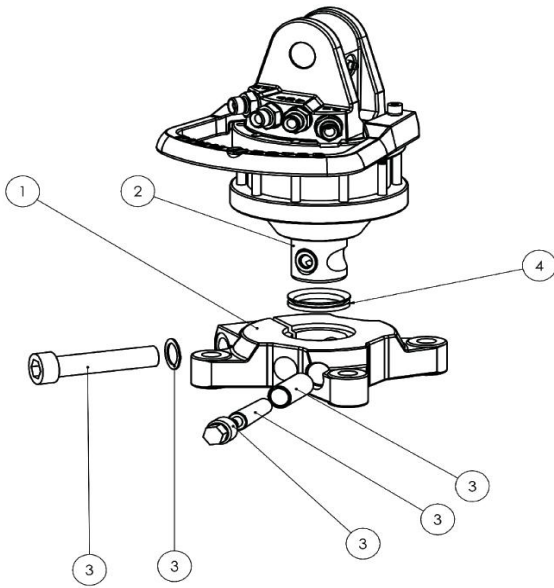

Description	Code Canimex	Code Fournisseur
1. Flasque/Flange CR400 F140	-	S70400-FL
2. Kit de réparation d'arbre F140/Shaft repair kit F140	-	S70400-SF
3. Kit de connexion flasque Flange connection kit	-	S70400-FC
4. Joint de la flasque Flange seal	-	S70400-FS

CR500

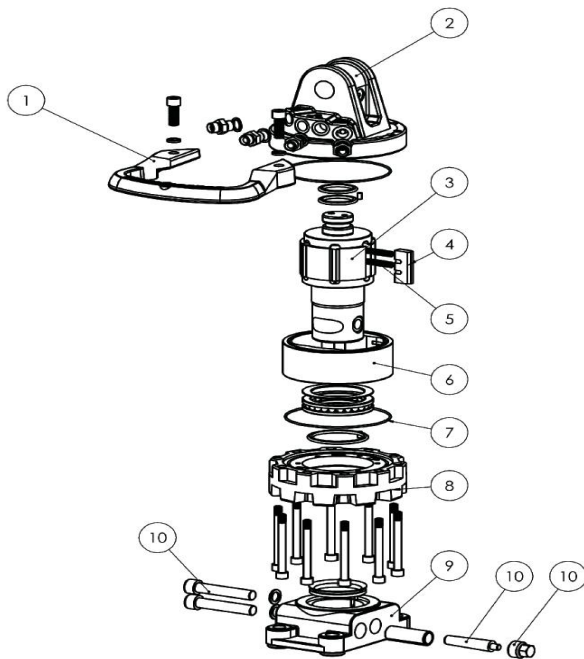

Description	Code Canimex	Code Fournisseur
1. Garde tuyau/Hose guard	-	S70500-HG
2. Couvert supérieur W30 Upper cover W30	-	S70500-UC
3. 3. Kit de réparation d'arbre F/Shaft repair kit F	-	S70500-SF
4. Ailettes/Wing kit	CR400 (Wing kit)	S70500-WI
5. Kit de ressort/Spring kit	CR400 (Spring kit)	S70500-SP
6. Stator	-	S70500-ST
7. Jeu de joints/Seal kit	SK CR400	S70500-SE
8. Couvert inférieur Lower cover	-	S70500-LC
9. Flasque/flange C500 F173	-	S70500-FL
10. Kit de connexion pour flasque/flange connection kit Boulons de côté/sidebolts M10x100 12.9 (10pcs) Boulons du garde tuyau/Hose guard bolts M12x35 (2pcs)	-	S70500-FC

# | NOTES



**At CANIMEX we redefine the meaning of service every day.**

The top-quality products we import, design, assemble and produce are supported by our proactive involvement.

More than just the way we do business. It's the way we like to do business. And that makes all the difference in the world to our customers – and to us.



Canimex head office

***Hydraulic and  
Electronic Division***

**CANIMEX INC.**  
285, Saint-Georges, Drummondville  
(Québec) Canada J2C 4H3  
1-855-777-1335 | 1-819-477-1335  
[canimex.com](http://canimex.com) | [hyd@canimex.com](mailto:hyd@canimex.com)

