



# Chain Coupling

Technical information



*Mechanical*  
Division

# CHAIN COUPLING

## COUPLINGS DIMENSIONS

TYPE	BORE		L	I	S	D	O	C	M +0.1 -0.0	N +0.25 -0.00	WT
	MIN	MAX									
3012	12	16	54.8	29.5	5.2	—	45	10.1	—	—	0.3
4012	12	22	79.4	36	7.4	35	62	14.4	32	23	0.8
4014	14	28	79.4	36	7.4	—	65	14.4	—	—	1.1
4016	14	32	87.4	40	7.4	51	77	14.4	48	25	1.4
5014	15	35	99.7	45	9.7	—	86	18.1	—	—	2.2
5016	16	40	99.7	45	9.7	63	93	18.1	60	29	2.7
5018	16	45	99.7	45	9.7	73.5	106	18.1	70	28	3.8
6018	20	56	123.5	55	11.5	85	127	22.8	85	23	6.2
6020	20	60	123.5	56	11.5	—	139	22.8	—	—	7.8
6022	20	71	123.5	56	11.5	—	151	22.8	—	—	10.4
8018	20	80	141.2	63	15.2	117	169	29.3	110	48	12.7
8020	20	90	145.2	65	15.2	—	185	29.3	—	—	16
8022	20	100	157.2	71	15.2	—	202	29.3	—	—	20.2
10020	25	110	178.8	80	18.1	—	233	35.8	—	—	33
12018	35	125	202.7	90	22.7	—	256	45.4	—	—	47
12022	35	140	222.7	100	22.7	—	304	45.4	—	—	72

## CASINGS DIMENSIONS

CASING #	A +1 -0	B +1 -0	O RING DIA ±0.25	SOCKET HEAD CAP SCREW 4 pcs *	E
3012	69	63	—	—	—
4012	77	72	—	—	—
4014	84	75	—	—	—
4016	92	72	5	M5x0.8x12	48
5014	101	85	—	—	—
5016	110	87	5.5	M6x1.0x15	70
5018	122	85	—	—	—
6018	142	105	5.5	—	96
6020	158	105	—	—	—
6022	168	117	—	—	—
8018	190	129	—	—	—
8020	210	137	—	—	—
8022	226	137	—	—	—
10020	281	153	—	—	—
12018	307	181	—	—	—
12022	357	218	—	—	—

— : N/A, TO BE ESTABLISHED WHEN ORDERING SO THAT COVERS & COUPLING FIT TOGETHER.

\* : FULL LENGTH OF THREAD  
2 GASKET OF 1.5mm APPROX. INCLUDED

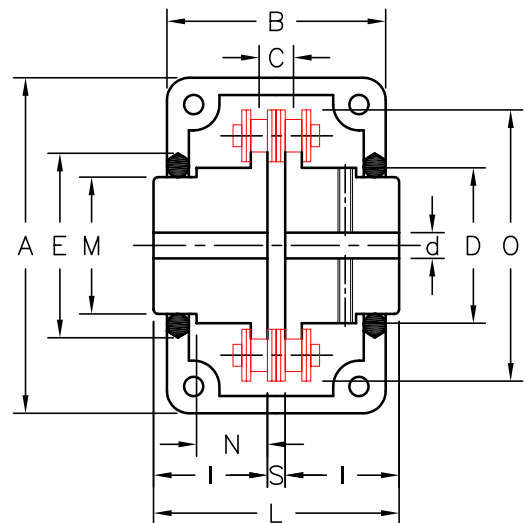

# CHAIN COUPLING

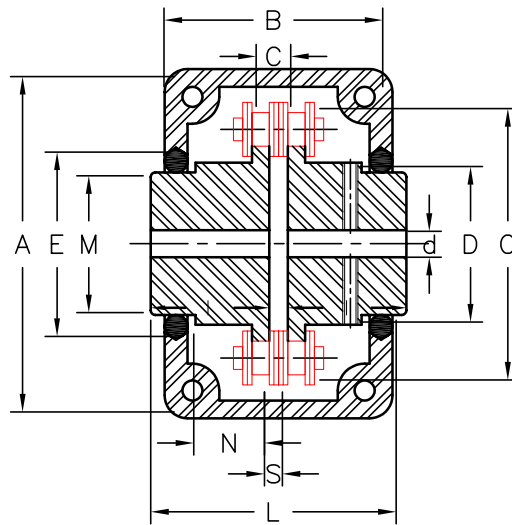
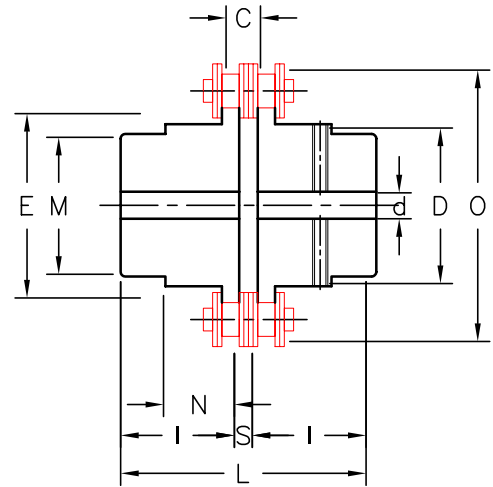
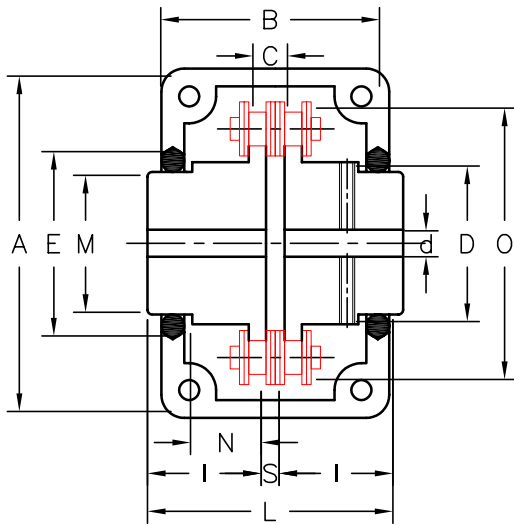

# CHAIN COUPLING

HUB DIMENSIONS				
TYPE	DIA KANA	DIA CHSSB	C R	MAX HUB
3012	35	35	28.89	25.26
4012	35	35	37.96	33.94
4014	43	43	45.96	42.18
4016	51.5	50	53.99	50.39
5014	53	55	57.09	52.92
5016	64	62	67.12	63.17
5018	73.5	70	77.15	73.39
6018	89.5	85	92.24	88.23
6020	102.5	100	104.31	100.46
6022	115	110	116.40	112.68
8018	115	110	122.47	117.89
8020	125	120	139.54	134.21
8022	142	140	154.55	150.50
10020	162	162	172.81	167.95
12018	173	170	182.89	177.21
12022	213	210	231.20	226.13

## Our service goes beyond...



Since 1969, Canimex has built its reputation in North America as representative for major international manufacturers of mechanical components. We are proud of our partnership with world leaders such as: COMER, SOM, TG...

Since our customers are our first priority, our main objective is to ensure their entire satisfaction. Want to innovate? You can count on the reliability and efficiency of our team of experts.

Always at your service!



Tel.: (819) 477.1335 • Fax: (819) 477.7212

Email: [mec@canimex.com](mailto:mec@canimex.com)

285, St-Georges, Drummondville (Québec) Canada J2C 4H3