

Voir la version française sur l'autre côté.

## **INSTALLATION**

When installing CANIMEX reducers, make sure to have a rigid mounting to maintain alignment. Flexible couplings are recommended because they minimize bearings and gears wear caused by misalignment. Mounting of reducers on bases, subject to vibration, should be avoided.

## **STARTING UP**

Check the oil level. Some speed reducers are shipped dry. Oil must be added prior to operation. Install the breather included in the box: the position will depend on the orientation of the reducer in its application. See the schematic below.

## **SELECTION OF LUBRICANT**

The reducers are normally filled up with mineral ISO VG320 oil (considering an application with an input speed of 1800 RPM in standard conditions of operation). See the table below for recommended choices of lubricant for different ranges of ambient temperature. The necessary oil quantity will vary depending on the orientation and inclination of the reducer. The level must clearly appear in the center of the sight glass when the reducer is not in operation.

## **MAINTENANCE & CHANGING LUBRICANT**

Shut off power before inspection. The oil level in the worm gear unit should be checked at least once a month. False reading will be avoided by examining the oil level before starting the unit.

To maintain proper ventilation of the unit, the hole in the breather plug (air vent) should be kept clean at all times. Inspect regularly set screws and reducer mounting bolts for tightness because loose fasteners might cause misalignment and excessive wear.

After 100 hours of running, a new worm gear unit must be drained, flushed and refilled with proper oil (see the table below). Thereafter, oil must be changed at least every 2,500 operating hours or every 6 months, whichever occurs first. Never mix two different types of oil. Make sure to drain and wash before using another type of oil.

For any non-standard applications or for any questions, please contact your Canimex sales representative.

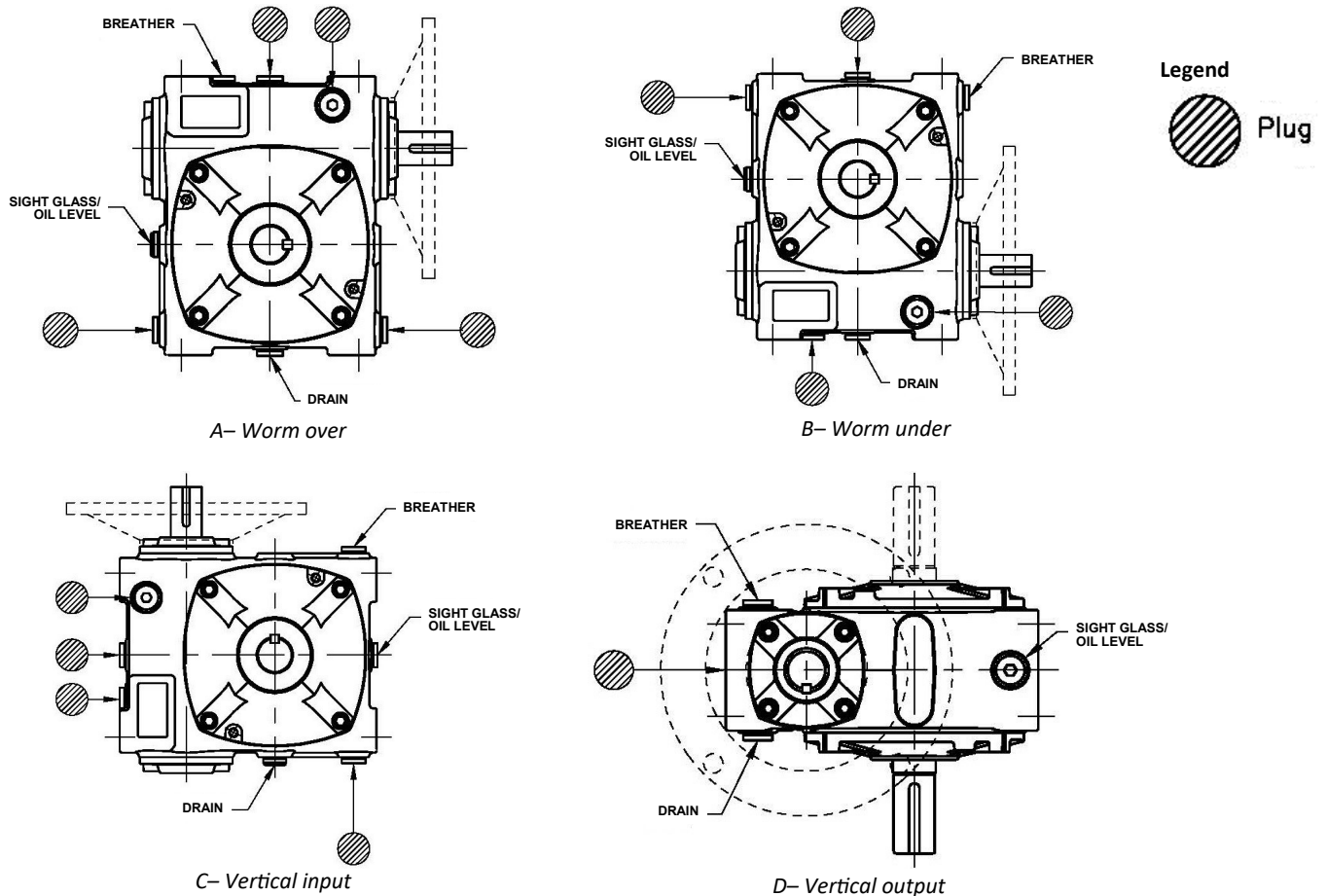

### Lubrication - Type of oil

Ambient temperature (°C)	Chevron		Shell		Mobil	
	Mineral	Synthetic	Mineral	Synthetic	Mineral	Synthetic
-30 to 0°C	Meropa Ultra gear 150	Meropa Synthetic EP 150	Omala S2 G150	Omala S4 WE 150	Mobilgear 600 XP 150	Mobil SHC 629
-5 to 15°C	Meropa Ultra gear 220	Meropa Synthetic EP 220 or 320	Omala S2 G220	Omala S4 WE 220 or 320	Mobilgear 600 XP 220	Mobil SHC 630 or 632
0 to 30°C	Meropa Ultra gear 320	Meropa Synthetic EP 320	Omala S2 G320	Omala S4 WE 320	Mobilgear 600 XP 320	Mobil SHC 632
30°C +	Meropa Ultra gear 460	Meropa Synthetic EP 460	Omala S2 G460	Omala S4 WE 460	Mobilgear 600 XP 460	Mobil SHC 634

*This table is for information purpose only (considering standards conditions of operation). For any application under non-standard conditions, please contact a Canimex sales representative.*